

FALLBROOK HEALTH & WELLNESS CENTER

1636 E. MISSION RD,
FALLBROOK, CA 92028



2825 Dewey Road, Unit 207
San Diego, CA 92106
Phone: 619.546.9670

FALLBROOK HEALTH & WELLNESS CENTER
 1636 E. MISSION RD
 FALLBROOK, CA 92028

BID SET 10/23/24 - NOT FOR CONSTRUCTION

ABBREVIATIONS

A.B.	ANCHOR BOLT	F.H.	FIRE HYDRANT	PLYWD.	PLYWOOD
A.C.	ASPHALT CONCRETE	FIN.	FINISH	P.T.	PRESSURE TREATED
A/C	AIR CONDITIONING	FIKT.	FIKTURE	R	RISER
ACOUS.	ACOUSTICAL	FLR.	FLOOR	RAD.	RADIUS
A.A.	AREA DRAIN	FLSH.	FLASHING	R.A.G.	RETURN AIR GRILLE
ADJ.	ADJACENT	FLW.	FLOW LINE	R.D.	ROOF DRAIN
A.F.F.	ABOVE FINISH FLOOR	FLUOR.	FLUORESCENT	RDWD.	REDWOOD
ALUM.	ALUMINUM	F.O.C.	FACE OF COLUMN	REF.	REFERENCE
ANOD.	ANODIZED	F.O.M.	FACE OF MASONRY	REFR.	REFRIGERATOR
A.P.	ACCESS PANEL	F.O.S.	FACE OF STUD	REG.	REGISTER
AUTO.	AUTOMATIC	FT	FEET OR FOOT	REIN.	REINFORCED
ARCH.	ARCHITECTURAL	F.S.	FLOOR SINK	REQD.	REQUIRED
		FTG.	FOOTING	RESL.	RESILIENT
BD.	BOARD	FLR(R)	FLOORING	RM.	ROOM
BIT.	BITUMINOUS			R.O.	ROUGH OPENING
BLDG.	BUILDING	GA.	GALVE	R.O.W.	RIGHT-OF-WAY
BLK(G).	BLOCKING	GALV.	GALVANIZED	R.S.	RESAWN
B.N.	BOUNDARY NAIL	G.I.	GALVANIZED IRON		
B.O.	BOTTOM OF	GYP.	GYPSPUM	S.A.G.	SUPPLY AIR GRILLE
BOT(T).	BOTTOM	H.B.	HOSE BIBB	S.A.R.	SUPPLY AIR REGISTER
B.S.	BOTH SIDES	H.C.	HOLLOW CORE	S.C.	SOLID CORE
BTW.	BETWEEN	HDBD.	HARD BOARD	SCHED.	SCHEDULE
		HDR.	HEADER	S.A.	STORM DRAIN
CAB.	CABINET	HDW.	HARDWARE	SECT.	SECTION
C.B.	CATCH BASIN	HDWD.	HARDWOOD	S.F.	SQUARE FEET
CEM.	CEMENT	H.M.	HOLLOW METAL	SH.	SHEET
C.F.	CUBIC FEET	HORZ.	HORIZONTAL	SHG.	SHEDDING
CFLASH.	COUNTER FLASHING	I.D.	INSIDE DIAMETER	SIM.	SIMILAR
C.I.	CAST IRON	I.E.	INVERT ELEVATION	S.M.	SHEET METAL
C.J.	CONTROL JOINT	INSUL.	INSULATION	S.O.V.	SHUT-OFF VALVE
CLG.	CLOSET	INT.	INTERIOR	SP.	SPACE(S)
CLOS.	CLOSET			SPECS.	SPECIFICATIONS
CLR.	CLEAR	JST.	JOIST	SQ.	SQUARE
C.O.	CLEAN OUT	JT.	JOINT	S.S.	STAINLESS STEEL
C.O.C.	CENTERLINE OF COLUMN	KIT	KITCHEN	STL.	STEEL
COL.	COLUMN	LAV.	LAVATORY	STOR.	STORAGE
CONC.	CONCRETE	LB.	POUND	STRUCT.	STRUCTURAL
COND.	CONDITION	L.B.	LAG BOLT	SUSP.	SUSPENDED
CONT.	CONTINUOUS	LT.	LIGHT	T.C.F.D.	TEMPORARY CERTIFICATE OF OCCUPANCY TREAD
CONTR.	CONTRACTOR			T.	TREAD
CONSTR.	CONSTRUCTION			T.O.C.	TOP OF CURB
CORR.	CORRIDOR			TEL(E)	TELEPHONE
C.S.	COUNTERSINK			T.O.F.	TOP OF FOOTING
C.T.	CERAMIC TILE			T.O.G.	TONGUE AND GROOVE
C.Y.	CUBIC YARD			THK	THICK
				T.N.	TOE NAIL
DEPT.	DEPARTMENT			T.O.	TOP OF
DET.	DETAIL			T.O.P.	TOP OF PARAPET
D.F.	DOUGLAS FIR OR DRINKING FOUNTAIN			T.O.S.	TOP OF SHEATHING
DIA.	DIAMETER			T.O.W.	TOP OF WALL
DIM.	DIMENSION			T.O.TR.	TOP OF TRELLIS
DISP.	DISPENSER			TYP.	TYPICAL
DN.	DOWN			U.O.N.	UNLESS OTHERWISE NOTED
D.S.	DOWNSPOUT			UR.	URINAL
DWG.	DRAWING			VERT.	VERTICAL
EA.	EACH			VEST.	VESTIBULE
E.A.G.	EXHAUST AIR GRILLE			VCT.	VINYL COMPOSITION TILE
E.J.	EXPANSION JOINT			V.T.R.	VENT THRU ROOF
ELEV.	ELEVATION			V.F.	VERIFY IN FIELD
ELEC.	ELECTRICAL			N.T.S.	NOT TO SCALE
EMER.	EMERGENCY				
E.N.	EDGE NAIL				
E.P.	ELECTRICAL PANEL				
EQ.	EQUAL				
EQUP.	EQUIPMENT				
E.S.	EACH SIDE				
E.W.C.	ELECTRIC WATER COOLER				
(E)	EXISTING				
EXT.	EXTERIOR				
F.A.	FIRE ALARM				
F.D.	FLOOR DRAIN				
F.D.C.	FIRE DEPT. CONNECTION				
F.E.	FIRE EXTINGUISHER				
F.F.	FACTORY FINISH OR FINISH FACE				
F.F.E.	FINISH FLOOR ELEVATION				

PROJECT DATA

PROJECT ADDRESS:	1636 E. MISSION RD, FALLBROOK, CA 92028
APN#:	760-197-04-00
LEGAL DESCRIPTION:	PUBLIC LAND SEC18-9-3W*SEQ*LEASE IN 12,000 SQ FT IN
ZONING DESIGNATION:	-
OVERLAY ZONE:	-
PROPOSED PROJECT:	
STORIES:	EXISTING BUILDING: 1 STORY [NO CHANGE] PROPOSED T.I.: 1 STORY [NO CHANGE]
TYPE OF CONSTRUCTION:	TYPE VB, FULLY SPRINKLERED
BUILDING AREA:	±7,500 SF
PROPOSED T.I. FLOOR AREA:	7,500 SF (INTERIOR T.I.)
YEAR BUILDING CONSTRUCTED:	-
EXISTING USE:	HEALTH & WELLNESS CENTER
PROPOSED USE:	HEALTH & WELLNESS CENTER
OCCUPANCY CLASSIFICATION:	B

SCOPE OF WORK

- EXISTING (2) MULTI-STALL RESTROOMS ON EAST WING TO BE DEMOLISHED AND REPLACED WITH NEW (2) SINGLE-USER / NON-GENDER RESTROOMS (75 SF EACH), NEW STORAGE ROOM (125 SF), NEW HALL (75 SF) ACCESS TO NEW SINGLE-USER RESTROOMS AND NEW PREP ROOM (125 SF)
- EXISTING (2) MULTI-STALL RESTROOMS ON WEST WING TO BE REMODELED (370 SF)
- NEW PLUMBING FIXTURES AND ACCESSORIES
- NEW INTERIOR FINISHES
- NEW NON-LOAD BEARING WALLS
- DEMO EXISTING PARTITION WALL AND REPLACE WITH NEW FOLDING PARTITION WALL

INDEX OF DRAWINGS

GENERAL	
T0.0	TITLE SHEET
T1.1	GENERAL NOTES
T1.2	ACCESSIBILITY NOTES
T1.3	ACCESSIBILITY NOTES
T1.4	ACCESSIBILITY NOTES
T1.5	ACCESSIBILITY NOTES
T1.6	ACCESSIBILITY NOTES
T1.7	ACCESSIBILITY NOTES
T2.0	CAL GREEN NOTES
T2.1	CAL GREEN NOTES
T2.2	CAL GREEN NOTES
INTERIOR DESIGN	
ID0.0	GENERAL NOTES
ID1.0	FINISH PLAN & SCHEDULES
ID2.0	ENLARGED RESTROOM PLANS AND ELEVATIONS - GENDER NEUTRAL
ID2.1	ENLARGED RESTROOM PLANS AND ELEVATIONS - MULTI STALL

PROJECT DIRECTORY

BUILDING OWNER & PROPERTY MANAGEMENT	FALLBROOK REGIONAL HEALTH DISTRICT 138 S. BRANDON RD FALLBROOK, CA 92028 TEL: (760) 731-9187 EMAIL: RMASON@FALLBROOKHEALTH.ORG CONTACT: RACHEL MASON
DESIGNER	ARCH5 DESIGN STUDIO 2825 DEWEY ROAD, UNIT 207 SAN DIEGO, CA 92106 TEL: (619) 546-9670 EMAIL: ADMIN@ARCH5.DESIGN CONTACT: RACHELLE DOMINGO-ROGERS

CURRENT GOVERNING CODES

ALL WORK AND MATERIALS SHALL BE IN ACCORDANCE WITH APPLICABLE REQUIREMENTS OF THE LOCAL FIRE MARSHALL, THE COUNTY OF SAN DIEGO BUILDING OFFICIALS AND UTILITY COMPANIES FURNISHING SERVICES. NOTHING IN THE PLANS OR SPECIFICATIONS SHALL BE CONSTRUCTED AS PERMITTING WORK THAT IS NOT IN CONFORMANCE WITH APPLICABLE CODES OR REGULATIONS. CODES GOVERNING THIS WORK INCLUDE, BUT ARE NOT LIMITED TO THE FOLLOWING:

- THE 2022 CALIFORNIA BUILDING (CBC) IS BASED ON THE 2021 IBC, BUT INCLUDES NUMEROUS STATE OF CALIFORNIA AMENDMENTS.
- THE 2022 CALIFORNIA ELECTRICAL CODE (CEC) IS BASED ON THE 2020 NEC WITH STATE OF CALIFORNIA AMENDMENTS.
- THE 2022 CALIFORNIA MECHANICAL CODE (CMC) IS BASED ON THE 2021 UMC WITH STATE OF CALIFORNIA AMENDMENTS.
- THE 2022 CALIFORNIA PLUMBING CODE (CPC) IS BASED ON THE 2021 UPC WITH STATE OF CALIFORNIA AMENDMENTS.
- THE 2022 CALIFORNIA ENERGY CODE.
- THE 2022 CALIFORNIA FIRE CODE
- THE 2022 CALIFORNIA AMENDMENTS AMERICANS WITH DISABILITIES ACT (CALIFORNIA BUILDING CODE - CHAPTER 11)
- THE 2022 CALIFORNIA GREEN BUILDING STANDARDS
- THE 2022 CALIFORNIA EXISTING BUILDING CODE
- ASSOCIATED CITY OF FAIR OAKS AMENDMENTS

THESE PLANS AND ALL NEW WORK SHALL COMPLY WITH THE CALIFORNIA BUILDING STANDARDS CODE FOUND IN THE STATE OF CALIFORNIA - TITLE 24 CCR AS AMENDED AND ADOPTED BY THE COUNTY OF SAN DIEGO.

REQUIREMENTS OF CODES AND REGULATIONS SHALL BE CONSIDERED AS MINIMUM. WHERE CONTRACT DOCUMENTS EXCEED W/O VIOLATING CODE AND REGULATION REQUIREMENTS, CONTRACT DOCUMENTS SHALL TAKE PRECEDENCE. WHERE CODES CONFLICT, THE MORE STRINGENT SHALL APPLY.

VICINITY MAP

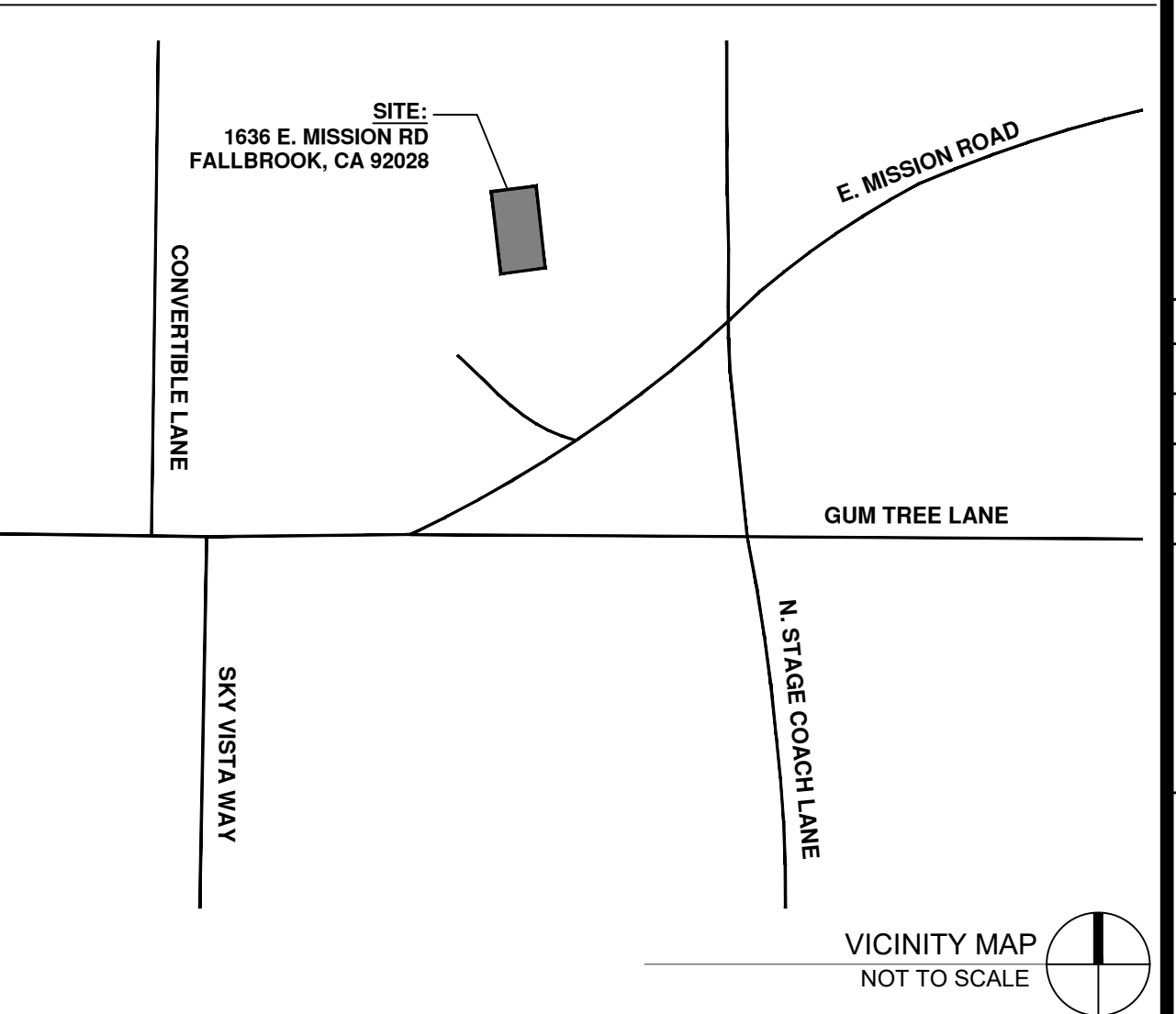

GRAPHIC SYMBOLS

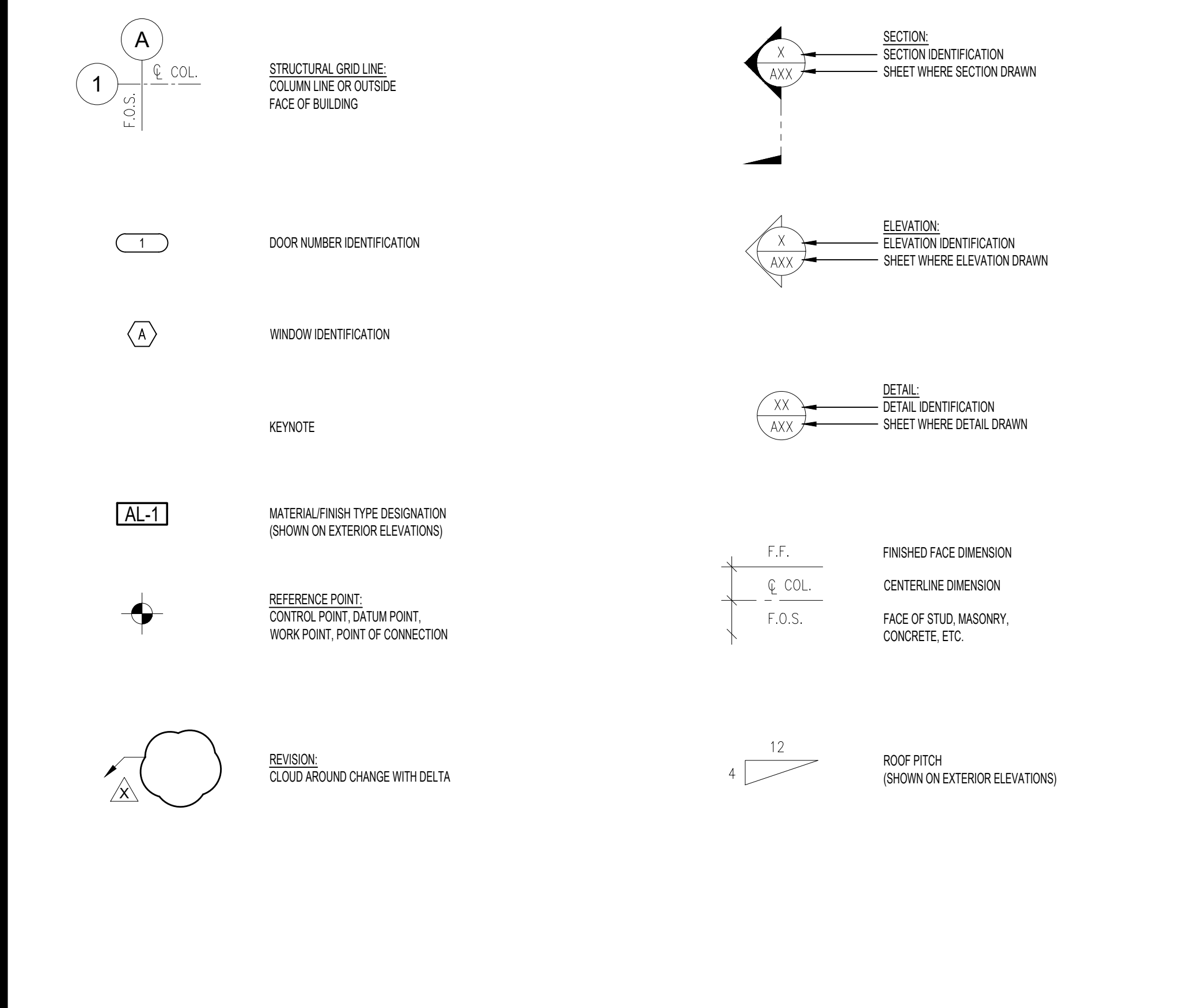

REVISIONS

DESCRIPTION	DATE
BID SET - NOT FOR CONSTRUCTION	10/23/24

Bid Issue Date: 10/23/24

Date: 10/23/24

Scale: AS NOTED

Project No.:

Sheet Title:

TITLE SHEET

Sheet No.:

T0.0

Any reproduction of these drawings is prohibited without written consent of Arch5 Design Studio. All dimensions and conditions on job site shall be verified prior to beginning of construction and shall immediately report any and all discrepancies to Designer.

FIRE DEPARTMENT NOTES

- BUILDINGS UNDERGOING CONSTRUCTION, ALTERATION OR DEMOLITION SHALL BE IN ACCORDANCE WITH CFC CH. 33.
- ADDRESS SHALL BE PROVIDED FOR ALL NEW AND EXISTING BUILDINGS IN A POSITION AS TO BE PLAINLY VISIBLE AND LEGIBLE FROM THE STREET OR ROAD FRONTING THE PROPERTY.
- DECORATIVE MATERIALS SHALL BE MAINTAINED IN A FLAME-RETARDANT CONDITION.
- AT LEAST ONE FIRE EXTINGUISHER WITH A MINIMUM RATING OF 2-A-10B:C SHALL BE PROVIDED WITHIN 75 FEET MAXIMUM TRAVEL DISTANCE FOR EACH 6,000 SQUARE FEET OR PORTION THEREOF ON EACH FLOOR. 2022 CFC 906.
- PROVIDE AN APPROVED MANUAL/AUTOMATIC FIRE ALARM SYSTEM. PLANS FOR THE FIRE ALARM SYSTEM SHALL BE SUBMITTED TO THE FIRE DEPARTMENT JURISDICTION FIRE PREVENTION BUREAU PRIOR TO INSTALLATION. 2022 CFC SECTION 901.
- A FIRE EXTINGUISHER LISTED AND LABELED FOR CLASS K FIRES SHALL BE INSTALLED WITHIN 30 FEET OF COMMERCIAL FOOD HEAT-PROCESSING EQUIPMENT.
- ALL VALVES CONTROLLING THE WATER SUPPLY FOR AUTOMATIC SPRINKLER SYSTEMS AND WATER-FLOW SWITCHES ON ALL SPRINKLER SYSTEMS SHALL BE ELECTRICALLY MONITORED WHERE THE NUMBER OF SPRINKLERS IS MORE THAN 6.
- FIRE-EXTINGUISHING SYSTEMS SHALL BE INSTALLED IN ACCORDANCE WITH CBC 904 AND COMPLY WITH CFC STANDARDS.
- ALL FIRE ALARM SYSTEMS SHALL BE IN ACCORDANCE WITH 2022 CFC SEC 907.
- ANY ROOM HAVING AN OCCUPANT LOAD OF 50 OR MORE PERSONS WHERE FIXED SEATS ARE NOT INSTALLED, AND WHICH IS USED FOR ASSEMBLY, CLASSROOM, DINING, DRINKING, OR SIMILAR PURPOSES, SHALL HAVE THE MAXIMUM CAPACITY OF THE ROOM POSTED ON AN APPROVED SIGN IN A CONSPICUOUS PLACE NEAR THE MAIN EXIT FROM THE ROOM. SHOW SIGN DESIGN AND LOCATION ON THE PLANS.
- ANYTIME A BUILDING IS OCCUPIED, THE MEANS OF EGRESS SHALL BE ILLUMINATED AT AN INTENSITY OF NOT LESS THAN 1 FOOTCANDLE AT THE FLOOR LEVEL.
- EGRESS ILLUMINATION REQUIRES A SOURCE OF EMERGENCY POWER ANYTIME TWO OR MORE EXITS ARE REQUIRED. FOR AN A-2 OCCUPANCY: WHEN OCC. LOAD IS 50 OR MORE PERSONS.
- PROVIDE AN APPROVED FIRE SPRINKLER SYSTEM IN ACCORDANCE WITH NFPA 13. PLANS FOR THE INSTALLATION OR MODIFICATION OF THE SPRINKLER SYSTEM SHALL BE SUBMITTED FOR APPROVAL TO CSFM PRIOR TO INSTALLATION. 2022 CFC SECTION 903.
- INTERIOR FINISHES AND COMBUSTIBLE DECORATIVE MATERIALS SHALL COMPLY WITH 2022 CFC SECTION 801.
- COMPLETE PLANS AND SPECIFICATIONS FOR FIRE ALARM SHALL BE SUBMITTED TO THE FIRE DEPARTMENT JURISDICTION SERVICES FOR REVIEW AND APPROVAL PRIOR TO INSTALLATION (2022 CFC 907.1.1).
- LOCATIONS AND CLASSIFICATIONS OF EXTINGUISHERS SHALL BE IN ACCORDANCE WITH 2022 CFC 906 AND CALIFORNIA CODE OF REGULATIONS (CCR) TITLE 19.
- DURING CONSTRUCTION, AT LEAST ONE EXTINGUISHER SHALL BE PROVIDED ON EACH FLOOR LEVEL AT EAH STAIRWAY, IN ALL STORAGE AND CONSTRUCTION SHEDS, IN LOCATIONS WHERE FLAMMABLE OR COMBUSTIBLE LIQUIDS ARE STORED OR USED, AND WHERE OTHER SPECIAL HAZARDS ARE PRESENT PER CFC SECTION 3315.1.
- COMPLETE PLANS AND SPECIFICATION FOR ALL FIRE EXTINGUISHER SYSTEMS, INCLUDING AUTOMATIC SPRINKLER AND STANDPIPE SYSTEMS INCLUDING AUTOMATIC SPRINKLER AND STANDPIPE SYSTEMS AND OTHER SPECIAL FIRE EXTINGUISHING SYSTEMS AND RELATED APPURTENANCES SHALL BE SUBMITTED TO THE FIRE DEPARTMENT JURISDICTION FOR REVIEW AND APPROVAL PRIOR TO INSTALLATION. 2022 CFC SECTIONS, 105.4.1, 107.2.1 AND 901.2
- IN BUILDINGS THAT REQUIRE STANDPIPES, STANDPIPES SHALL BE PROVIDED DURING CONSTRUCTION WHEN THE HEIGHT REACHES 40 FEET ABOVE THE LOWEST LEVEL OF FIRE DEPARTMENT VEHICLE ACCESS. A FIRE DEPARTMENT CONNECTION SHALL BE NO MORE THAN 100 FEET FROM AVAILABLE FIRE DEPARTMENT VEHICLE ACCESS ROADWAYS.
- BUILDINGS UNDERGOING CONSTRUCTION, ALTERATION, OR DEMOLITION SHALL CONFORM TO CFC CHAPTER 33. WELDING, CUTTING, AND OTHER HOT WORK SHALL IN CONFORMANCE WITH 2022 CFC CHAPTER 35.
- KEY BOXES SHALL BE PROVIDED FOR ALL HIGH-RISE BUILDINGS, POOL ENCLOSURES, GATES IN THE PATH OF FIREFIGHTER TRAVEL TO STRUCTURES, SECURED PARKING LEVELS, DOORS GIVING ACCESS TO ALARM PANELS AND/OR ANNUNCIATORS, AND ANY OTHER STRUCTURES OR AREAS WHERE ACCESS TO AN AREA IS RESTRICTED.
- ALL CODE REFERENCES ARE TO BE IN COMPLIANCE WITH THE HEALTH AND SAFETY CODE (HSC) SECTION 13145. CALIFORNIA CODE OF REGULATIONS (CCR), TITLE 19 AND TITLE 24, 2022 EDITION.
- FIRE DEPARTMENT INSPECTIONS AREA REQUIRED. SCHEDULE ALL INSPECTIONS 2 DAYS IN ADVANCE.
- A DETAILED LETTER CLEARLY IDENTIFYING ALL INTENDED USE(S) AND OPERATION(S) OF THE STRUCTURE(S) SHALL BE PROVIDED TO THE FIRE DEPARTMENT ALONG WITH THE SUBMITTALS.
- IF ADDITIONS OF WALLS AND/OR OTHER TENANT IMPROVEMENTS OBSTRUCT OR EFFECT COVERAGE OR PERFORMANCE OF THE FIRE SPRINKLER SYSTEM AND/OR IF ANY MODIFICATION OF THE FIRE SPRINKLER SYSTEM IS NECESSARY, FIRE SPRINKLER TENANT IMPROVEMENT PLANS SHALL BE SUBMITTED TO CALIFORNIA STATE FIRE MARSHAL FOR APPROVAL PRIOR TO INSTALLATION.
- EXIT DOOR SHALL SWING IN THE DIRECTION OF EXIT TRAVEL WHEN SERVING MORE THAN (50) PERSONS.
- PROVIDE FIRE DEPARTMENT ACCESS TO THE FACILITY. "KNOX" KEY DEVICES ARE AVAILABLE FOR USE IN THE CITY. EXISTING BUILDING HAS APPROVED KNOX BOX LOCATION PER SHELL BUILDING PLANS.
- PROVIDE KEYS TO FIRE DEPARTMENT TO PLACE IN KNOX BOX FOR EMERGENCY ACCESS. 2022 CALIFORNIA FIRE CODE CHAPTER 5 SECTION 506.2.
- ELECTRICAL:
ALL CIRCUIT BREAKERS SHALL BE LABELED TO CLEARLY INDICATE AREAS SERVED. THE MAIN ELECTRICAL SHUT-OFF SHALL BE IDENTIFIED WITH EITHER THE BUSINESS NAME OR THE BUSINESS ADDRESS. 2023 NFPA 70
- NATURAL GAS:
THE MAIN GAS SHUT-OFF TO THE BUILDING SHALL BE LABELED WITH EITHER THE BUSINESS NAME OR THE BUSINESS ADDRESS. PROTECTIVE STEEL POSTS FILLED WITH CONCRETE SHALL BE PLACED AROUND ALL METERS SUBJECT TO VEHICULAR TRAFFIC. CFC SECTION 304.1.
- EXTERIOR FIRE SPRINKLER RISER, FIRE ALARM BELL AND KNOX BOX SHALL BE UNOBSTRUCTED AT ALL TIMES AND NOT PAINTED OVER.**
- NEW AND EXISTING BUILDINGS SHALL HAVE APPROVED ADDRESS NUMBERS, BUILDING NUMBERS OR APPROVED BUILDING IDENTIFICATION PLACED IN A POSITION THAT IS PLAINLY LEGIBLE AND VISIBLE FROM THE STREET OR ROAD FRONTING THE PROPERTY. THESE NUMBERS SHALL CONTRAST IN COLOR TO BACKGROUND. NUMBERS SHALL BE MINIMUM OF 4" HIGH WITH A MINIMUM STROKE WIDTH OF ½ INCH. CFC SECTION 505.1.
- STORAGE OF "HAZARDOUS MATERIALS" OR "HIGH PILED STORAGE" IS NOT PROPOSED.
- PER CFC 506.1, WHERE ACCESS TO OR WITHIN A STRUCTURE OR AN AREA IS RESTRICTED BECAUSE OF SECURED OPENINGS OR WHERE IMMEDIATE ACCESS IS NECESSARY FOR LIFE-SAVING OR FIRE-FIGHTING PURPOSES, THE FIRE CODE OFFICIAL IS AUTHORIZED TO REQUIRE A KEY BOX TO BE INSTALLED IN AN APPROVED LOCATION. THE KEY BOX SHALL CONTAIN KEY(S) TO GAIN NECESSARY ACCESS AS REQUIRED BY THE FIRE CODE OFFICIAL.

- REQUESTS FOR INSPECTIONS SHALL BE MADE 48 HOURS IN ADVANCE. INSPECTIONS SHALL BE MADE ONCE WORK IS COMPLETE, UTILIZING APPROVED AND STAMPED PLANS. CONTRACTOR SHALL BE REQUIRED TO HAVE THE APPROVED PLANS ON SITE PER CODE.
- FIRE DEPARTMENT ACCESS FOR USE OF FIREFIGHTING EQUIPMENT SHALL ALWAYS BE PROVIDED TO THE IMMEDIATE JOB CONSTRUCTION SITE AT THE START OF CONSTRUCTION AND MAINTAINED UNTIL CONSTRUCTION AND MAINTAINED UNTIL CONSTRUCTION IS COMPLETED. ACCESS TO EACH PHASE OF DEVELOPMENT SHALL BE TO THE SATISFACTION OF THE CITY ENGINEER AND/OR CITY FIRE MARSHAL.
- PRIOR TO DELIVERY OF COMBUSTIBLE BUILDING MATERIAL ON SITE, THE APPROVED VEHICLE ACCESS FOR FIREFIGHTING SHALL BE INSTALLED, SATISFACTORILY PASS ALL REQUIRED TESTS AND APPROVED BY THE CITY. ALL ACCESSES SHALL BE PROVIDED WITHIN 100' OF ALL FIRE DEPARTMENT CONNECTIONS. USE OF TEMPORARY VEHICLE ACCESS FOR FIGHTING MAY REQUIRE PLAN SUBMITTAL, REVIEW AND APPROVAL BY THE CITY.

STORMWATER NOTES

- THE CONTRACTOR SHALL BE RESPONSIBLE FOR CLEANUP OF ALL SILT & MUD ON ADJACENT STREET(S), DUE TO CONSTRUCTION VEHICLES OF ANY OTHER CONSTRUCTION ACTIVITY, AT THE END OF EACH WORK DAY, OR AFTER A STORM EVENT THAT CAUSES A BREACH IN INSTALLED CONSTRUCTION BMP'S WHICH MAY COMPROMISE STORM WATER QUALITY WITHIN ANY STREET(S). A STABILIZED CONSTRUCTION EXIT MAY BE REQUIRED TO PREVENT CONSTRUCTION VEHICLES OR EQUIPMENT FROM TRACKING MUD OR SILT ON TO THE STREET.
- ALL STOCKPILES OF SOIL &/OR BUILDING MATERIALS THAT ARE INTENDED TO BE LEFT FOR A PERIOD GREATER THAN 7 CALENDAR DAYS ARE TO BE COVERED. ALL REMOVABLE BMP DEVICES SHALL BE IN PLACE AT THE END OF EACH WORKING DAY WHEN THE 5 DAY RAIN PROBABILITY FORECAST EXCEEDS 40%.
- A CONCRETE WASHOUT AREA SHALL BE PROVIDED ON ALL PROJECTS WHICH PROPOSE THE CONSTRUCTION OF ANY CONCRETE IMPROVEMENT WHICH ARE TO BE POURED IN PLACE ON SITE.
- THE CONTRACTOR SHALL RESTORE ALL EROSION/SEDIMENT CONTROL DEVICES TO WORKING ORDER AFTER EACH RUN-OFF PRODUCING RAINFALL OR AFTER ANY MATERIAL BREACH IN EFFECTIVENESS.
- ALL SLOPES THAT ARE CREATED OR DISTURBED BY CONSTRUCTION ACTIVITY MUST BE PROTECTED AGAINST EROSION AND SEDIMENT TRANSPORT AT ALL TIMES.
- THE STORAGE OF ALL CONSTRUCTION MATERIALS AND EQUIPMENT MUST BE PROTECTED AGAINST ANY POTENTIAL RELEASE OF POLLUTANT INTO THE ENVIRONMENT.
- STORM WATER FROM DOWNSPOUTS AND IMPERVIOUS AREAS SHALL BE DISPERSE ONTO LANDSCAPE.
- THE PROJECT PROPOSED TO EXPORT 0 CUBIC YARDS OF MATERIAL FROM THIS SITE. ALL EXPORT MATERIAL SHALL BE DISCHARGED TO A LEGAL DISPOSAL SITE. THE APPROVAL OF THIS PROJECT DOES NOT ALLOW PROCESSING AND SALE OF THE MATERIAL. ALL SUCH ACTIVITIES REQUIRE A SEPARATE CONDITIONAL USE PERMIT.

GENERAL NOTES

DESIGNER'S STATEMENT:

- OVERLAPPING & CONFLICTING REQUIREMENTS: WHERE COMPLIANCE WITH TWO OR MORE INDUSTRY STANDARDS OR SETS OF REQUIREMENTS IS SPECIFIED, AND OVERLAPPING OF THOSE DIFFERENT STANDARDS OR REQUIREMENTS ESTABLISHES CONFLICTING LEVELS OF QUALITY, THE MOST STRINGENT STANDARD SHALL BE ENFORCED, UNLESS SPECIFICALLY NOTED OTHERWISE. CONSULT WITH THE DESIGNER/ENGINEER BEFORE PROCEEDING.
- MINIMUM QUALITY / QUANTITY: INTENDED AS MINIMUM FOR THE WORK TO BE PERFORMED OR PROVIDED, EXCEPT WHERE NOTED OTHERWISE. ACTUAL WORK MY EITHER COMPLY EXACTLY WITH THAT MINIMUM, OR MAY EXCEED THAT MINIMUM WITHIN REASONABLE LIMITS.
- NOTE TO CONTRACTOR: WHERE CONTRACT DOCUMENTS (DRAWINGS AND SPECIFICATIONS) ARE INCOMPLETE, AMBIGUOUS OR CONTAIN CONFLICTING INSTRUCTIONS, DO NOT PROCEED UNTIL RECEIVING CLARIFICATION FROM THE DESIGNER IN WRITING. IT IS THE GENERAL CONTRACTOR'S RESPONSIBILITY TO ENSURE ALL BUILDING SYSTEMS, NEW AND EXISTING, ARE IN GOOD WORKING ORDER WHEN TURNED OVER TO THE OWNER.

GENERAL:

- THE SPECIFICATIONS, INCLUDED HERewith, ARE AN INTEGRAL PART OF THESE CONTRACT DOCUMENTS AND ALL CONDITIONS MENTIONED IN EITHER SHALL BE EXECUTED AS THOUGH SPECIFICALLY MENTIONED IN BOTH.
- CONTRACTORS/SUBCONTRACTORS SHALL FIELD VERIFY ALL LOCATIONS, DIMENSIONS, AND CONDITIONS OF WALLS, DOORS, PLUMBING, MECHANICAL ELECTRICAL ITEMS, ETC. (WHETHER SHOWN OR NOT SHOWN ON THE DRAWINGS) PRIOR TO START OF CONSTRUCTION. CONTRACTOR TO ADVISE THE ARCHITECT OF ANY ADVERSE CONDITIONS OR DISCREPANCIES.

GENERAL CONSTRUCTION NOTES:

- ALL CONSTRUCTION AND PROCEDURES SHALL CONFORM TO ALL APPLICABLE CODES AS OUTLINED ON TITLE SHEET.
- DO NOT SCALE DRAWINGS. IF DIMENSIONAL DISCREPANCIES OCCUR BETWEEN PLANS AND EXISTING CONDITIONS, CONTACT ARCHITECT IMMEDIATELY TO RESOLVE CONFLICT PRIOR TO CONTINUATION OF WORK.
- EXISTING WALLS WERE CONSTRUCTED WITH OTHER PERMITS AND/OR CONTRACTS. FIELD VERIFY CONSTRUCTION AND WIDTH PRIOR TO FABRICATION OF DOOR FRAMES OR COMPONENTS WHICH REQUIRE THE WIDTH OF THE WALL TO BE SET
- CONTRACTOR TO FIELD VERIFY EXISTING CONDITIONS AND NOTIFY ARCHITECT WHEN THOSE CONDITIONS DIFFER FROM THE CONSTRUCTION DOCUMENTS.
- ALL EXTERIOR DOORS AND WINDOWS SHALL BE FULLY WEATHER STRIPPED; MANUFACTURED UNITS SHALL MEET ANSI AND TITLE 24 STANDARDS FOR AIR INFILTRATION.
- ALL JOINTS AND PENETRATIONS IN THE BUILDING ENVELOPE SHALL BE CAULKED AND SEALED.
- COORDINATE WITH ARCHITECT TO PROVIDE BLOCKING IN WALLS WHERE ACCESSORY ITEMS ARE INSTALLED TYPICAL: GRAB BARS, TOILET PAPER DISPENSERS, ETC.
- REFER TO WALL TYPES AND CROSS-HATCHED AREAS ON FLOOR PLANS FOR LOCATIONS OF ONE-HOUR FIRE RATED PARTITIONS IF APPLICABLE
- ALL DIMENSIONS SHOWN ARE TO FINISHED FACE OF WALL
- FURNITURE AND MODULAR SYSTEMS FURNITURE ARE SHOWN FOR REFERENCE ONLY AND ARE NOT PART OF PROJECT SCOPE.
- ALL PENETRATIONS THROUGH FIRE RATED PARTITIONS SHALL BE PROTECTED WITH A U.L. LISTED FIRE STOP SYSTEM.
- ALL PENETRATIONS @ WALLS THAT HAVE SOUND INSULATION SHALL BE SEALED WITH NON-HARDENING ACOUSTICAL SEALANT.

GREEN BUILDING CODE REQUIREMENTS:

- DOCUMENTATION:
A BUILDING "SYSTEMS MANUAL" AS LISTED IN CGC SECTION 5.410.2.5 SHALL BE DELIVERED TO THE BUILDING OWNER OR REPRESENTATIVE AND THE REPRESENTATIVE AND THE FACILITIES OPERATOR. THE "SYSTEMS MANUAL" SHALL CONTAIN THE REQUIRED FEATURES LISTED IN CGC SECTION 5.410.2.5.1.
- POLLUTANT CONTROL:
DURING CONSTRUCTION, ENDS OF DUCT OPENINGS ARE TO BE SEALED, AND MECHANICAL EQUIPMENT IS TO BE COVERED. CGC 5.504.3.
- POLLUTANT CONTROL:
VOC'S MUST COMPLY WITH THE LIMITATIONS LISTED IN SECTION 5.504.4 AND TABLES 4.504.1, 5.504.4.1, 5.504.4.2, 5.504.4.3, AND 5.504.4.5 FOR: ADHESIVES, SEALANTS, PAINTS AND COATINGS, CARPET AND COMPOSITION WOOD PRODUCTS. CGC 5.504.4.
- POLLUTANT CONTROL:
MECHANICALLY VENTILATED BUILDINGS SHALL PROVIDE REGULARLY OCCUPIED AREAS WITH AIR FILTRATION MEDIA FOR OUTSIDE AND RETURN AIR THAT PROVIDES AT LEAST A MINIMUM EFFICIENCY REPORTING VALUE (MERV) OF 13. MERV 13 FILTERS SHALL BE INSTALLED PRIOR TO OCCUPANCY. CGC SECTION 5.504.5.3.
- POLLUTANT CONTROL:
WHERE OUTDOOR AREAS ARE PROVIDED FOR SMOKING, SUCH AREAS ARE PROHIBITED WITHIN 25' OF BUILDING ENTRIES, WINDOWS AND OUTDOOR AIR INTAKES. SIGNAGE SHALL BE POSTED TO INFORM OCCUPANTS OF THE PROHIBITIONS. CGC SECTION 5.504.7.
- ENVIRONMENTAL COMFORT:
WALL AND FLOOR ASSEMBLIES SEPARATING TENANT SPACES AND TENANT SPACES FROM PUBLIC SPACES) SHALL HAVE AN STC OF AT LEAST 40. CGC SECTION 5.504.7.3.
- ENVIRONMENTAL COMFORT:
WALL AND ROOF ASSEMBLIES EXPOSED TO NOISE SOURCES SHALL HAVE AN STC RATING OF AT LEAST 50, WITH EXTERIOR WINDOWS HAVING A MINIMUM STC OF 40 IN THE FOLLOWING LOCATIONS, PER CGC SECTION 5.507.4.1:
a) WITHIN THE 65 CNEL NOISE-CONTOUR OF A FREEWAY, RAILROAD, OR INDUSTRIAL SOURCE, AS DETERMINED BY THE JURISDICTION'S NOISE ELEMENT OF THE GENERAL PLAN.
b) WITHIN THE 65 CNEL NOISE-CONTOUR OF AN AIRPORT.
- OUTDOOR AIR QUALITY:
INSTALLATIONS OF HVAC, REFRIGERATION AND FIRE SUPPRESSION SYSTEMS WILL NOT CONTAIN CFC's OR HALONS, PER CGC 5.508.1.
- PRIOR TO FINAL INSPECTION THE LICENSED CONTRACTOR, ARCHITECT, OR ENGINEER IN RESPONSIBLE CHARGE OF THE OVERALL CONSTRUCTION MUST PROVIDE TO THE BUILDING DEPARTMENT OFFICIAL **WRITTEN VERIFICATION** THAT ALL APPLICABLE PROVISIONS FOR THE GREEN BUILDING STANDARDS CODE HAVE BEEN IMPLEMENTED AS PART OF THE CONSTRUCTION. CGC 102.3.

Any reproduction of these drawings is prohibited without written consent of Arch5 Design Studio. All dimensions and conditions on job site shall be verified prior to beginning of construction and shall immediately report any and all discrepancies to Designer.

arch5 design

2825 Dewey Road, Unit 207
San Diego, CA 92106
Phone: 619.546.9670

FALLBROOK
HEALTH & WELLNESS CENTER
1636 E. MISSION RD
FALLBROOK, CA 92028

REVISIONS

DATE	DESCRIPTION

Bid Issue Date: TBD

Date: 10/23/24

Scale: AS NOTED

Project No.:

Sheet Title:

GENERAL NOTES

Sheet No.:

T1.1

BID SET 10/23/24 - NOT FOR CONSTRUCTION

Any reproduction of these drawings is prohibited without written consent of Arch5 Design Studio. All dimensions and conditions on job site shall be verified prior to beginning of construction and shall immediately report any and all discrepancies to Designer.

11B-213.3.3 Urinals. Where one or more urinals are provided, at least ten percent but no fewer than one shall comply with Section 11B-605.

11B-213.3.4 Lavatories. Where lavatories are provided, at least ten percent but no fewer than one shall comply with Section 11B-606 and shall not be located in a toilet compartment.

11B-213.3.5 Mirrors. Where mirrors are provided, at least one shall comply with Section 11B-603.3.

11B-213.3.6 Bathing Facilities. Not Applicable.

11B-213.3.7 Coat Hooks & Shelves. Where coat hooks or shelves are provided in toilet rooms without toilet compartments, at least one of each type shall comply with Section 11B-603.4. Where coat hooks or shelves are provided in toilet compartments, at least one of each type complying with Section 11B-604.8.3 shall be provided in toilet compartments required to comply with Section 11B-213.3.1.

11B-214 Washing Machines & Clothes Dryers

11B-214.1 General. Not Applicable.

11B-215 Fire Alarm Systems & Carbon Monoxide Alarm Systems

11B-215.1 General. Where fire alarm systems and carbon monoxide alarm systems provide audible alarm coverage, alarms shall comply with Section 11B-215.

Exception: In existing facilities, visible alarms for fire alarm systems shall not be required except where an existing fire alarm system is upgraded or replaced, or a new fire alarm system is installed.

11B-215.2 Public Use Areas. Alarms in public use areas shall comply with Chapter 9, Section 907.5.2.3.1.

11B-215.3 Employee Work Areas. Where employee work areas have audible alarm coverage, the wiring system shall be designed so that visible alarms complying with Chapter 9, Section 907.5.2.3.1, Exception can be integrated into the alarm system.

11B-215.4 Transient Lodging. Not Applicable.

11B-215.5 Residential Facilities. Not Applicable.

11B-216 Signs

11B-216.1 General. New or altered signs shall be provided in accordance with Section 11B-216 and shall comply with Section 11B-703. The addition of or replacement of signs shall not trigger any additional path of travel requirements.

Exception: Building directories, menus, seat and row designations in assembly areas, occupant names, building addresses, and company names and logos shall not be required to comply with Section 11B-216.

11B-216.2 Designations. Interior and exterior signs identifying permanent rooms and spaces shall comply with Sections 11B-703.1, 11B-703.2, 11B-703.3 and 11B-703.5. Where pictograms are provided as designations of permanent rooms and spaces, the pictograms shall comply with Section 11B-703.6 and shall have text descriptors complying with Sections 11B-703.2 and 11B-703.5.

Exception: Exterior signs that are not located at the door to the space they serve shall not be required to comply with Section 11B-703.2.

11B-216.4.2 Areas of Refuge & Exterior Areas for Assisted Rescue. Not Applicable.

11B-216.4.3 Directional Signs. Signs required by Chapter 10, Section 1009.10 to provide directions to accessible means of egress shall comply with Section 11B-703.5.

11B-216.4.4 Delayed Egress Locks. Not Applicable.

11B-216.5 Parking. Signs identifying parking spaces and signs within parking facilities shall comply with Section 11B-216.5.

11B-216.5.1 Parking Spaces. Parking spaces complying with Section 11B-502 shall be identified by signs complying with Sections 11B-502.6 and 11B-502.8.

11B-216.5.2 Parking Facilities. Signs within parking facilities shall comply with Section 11B-216.5.2.

11B-216.5.2.1 Signs Intended for Use by Pedestrians. Signs intended for use by pedestrians within parking facilities, including directional or informational signs indicating parking sections or levels, shall comply with the requirements of Section 11B-216.

11B-216.5.2.2 Additional Signs. Signs within parking facilities containing parking spaces complying with Section 11B-502 shall comply with Section 11B-502.8.

11B-216.6 Entrances. In existing buildings and facilities where not all entrances comply with Section 11B-404, entrances complying with Section 11B-404 shall be identified by the International Symbol of Accessibility complying with Section 11B-703.2.1. Directional signs complying with Section 11B-703.5 that indicate the location of the nearest entrance complying with Section 11B-404 shall be provided at entrances that do not comply with Section 11B-404. Directional signs complying with Section 11B-703.5, including the International Symbol of Accessibility complying with Section 11B-703.2.1, indicating the accessible route to the nearest accessible entrance shall be provided at junctions when the accessible route diverges from the regular circulation path.

11B-216.7 Elevators. Where existing elevators do not comply with Section 11B-407, elevators complying with Section 11B-407 shall be clearly identified with the International Symbol of Accessibility complying with Section 11B-703.2.1. Existing buildings that have been modeled to provide specific elevators for public use that comply with these building standards shall have the location of and the directions to these elevators posted in the building lobby on a sign complying with Section 11B-703.5, including the International Symbol of Accessibility complying with Section 11B-703.2.1.

11B-216.8 Toilet Rooms. Where existing toilet rooms do not comply with Section 11B-603, directional signs indicating the location of the nearest toilet room complying with Section 11B-603 within the facility shall be provided. Signs shall comply with Section 11B-703.5 and shall include the International Symbol of Accessibility complying with Section 11B-703.2.1. Where existing toilet rooms do not comply with Section 11B-603, the toilet rooms complying with Section 11B-603 shall be identified by the International Symbol of Accessibility complying with Section 11B-703.2.1. Existing buildings that have been remodeled to provide specific toilet rooms for public use that comply with these building standards shall have the location of and the directions to these rooms posted in or near the building lobby or entrance on a sign complying with Section 11B-703.5, including the International Symbol of Accessibility complying with Section 11B-703.2.1.

11B-216.8.1 Geometric Symbols. Geometric symbols complying with Section 11B-703.7.2.6 shall be provided at entrances to toilet and bathing rooms.

11B-216.9 TTYs. Not Applicable.

11B-216.10 Assistive Listening Systems. Not Applicable.

11B-216.11 Check-out Aisles. Not Applicable.

11B-216.12 Amusement Rides. Not Applicable.

11B-217 Telephones

11B-217.1 General. Not Applicable

11B-218 Transportation Facilities

11B-218.1 General. Not Applicable.

11B-219 Assistive Listening Systems

11B-219.1 General. Not Applicable.

11B-220 Automatic Teller Machines, Fare Machines & Point-of-Sale Devices

11B-220.1 Automatic Teller Machines & Fare Machines. Not Applicable.

11B-220.2 Point-of-Sale Devices. Where point-of-sale devices are provided, all devices at each location shall comply with Sections 11B-707.3, 11B-707.7.2, and 11B-707.9. Where point-of-sale devices are provided at check stands and sales and service counters required to comply with Sections 11B-227.2 and 11B-227.3, they shall comply with Sections 11B-707.2, 11B-707.3, 11B-707.7.2, and 11B-707.9.

Exceptions:
Where a single point-of-sale device is installed for use with any type of motor fuel, it shall comply with Sections 11B-707.2, 11B-707.3, 11B-707.7.2, and 11B-707.9. Where more than one point-of-sale device is installed for use with a specific type of motor fuel, a minimum of two for that type shall comply with Sections 11B-707.2, 11B-707.3, 11B-707.7.2, and 11B-707.9. Types of motor fuel include, but are not limited to, gasoline, diesel, compressed natural gas, methanol, or ethanol.

Point-of-sale devices at electric vehicle charging stations required to comply with Section 11B-812 shall comply with Section 11B-812.10.3.

11B-221 Assembly Areas Not Applicable.

11B-222 Dressing, Fitting & Locker rooms

11B-222.1 General. Where dressing rooms, fitting rooms, or locker rooms are provided, at least 5 percent, but no fewer than one, of each type of use in each cluster provided shall comply with Section 11B-803.

Exception: In alterations, where it is technically infeasible to provide rooms in accordance with Section 11B-222.1, one room for each sex on each level shall comply with Section 11B-803. Where only unisex rooms are provided, unisex rooms shall be permitted.

11B-222.2 Coat Hooks & Shelves. Not Applicable.

11B-222.3 Mirrors. Not Applicable.

11B-223 Medical Care & Long-Term Care Facilities Not Applicable.

11B-224 Transient Lodging Guest Rooms, Housing at a Place of Education & Social Service Center Establishments Not Applicable.

11B-225 Storage

11B-225.1 General. Storage facilities shall comply with Section 11B-225.

11B-225.2 Storage. Where storage is provided in accessible spaces, at least one of each type shall comply with Section 11B-811.

11B-225.2.1 Lockers. Where lockers are provided, at least 5 percent, but no fewer than one of each type, shall comply with Section 11B-811.

11B-225.2.2 Self-Service Shelving. Self-service shelves shall be located on an accessible route complying with Section 11B-402. Self-service shelving shall not be required to comply with Section 11B-308.

11B-225.2.3 Library Book Stacks. Not Applicable.

11B-225.3 Self-Service Storage Facilities. Not Applicable.

11B-226 Dining Surfaces & Work Surfaces

11B-226.1 General. Where dining surfaces are provided for the consumption of food or drink, at least 5 percent of the seating spaces and standing spaces at the dining surfaces shall comply with Section 11B-902. In addition, where work surfaces are provided for use by other than employees, at least 5 percent shall comply with Section 11B-902.

Exceptions:
1. Sales counters and service counters shall not be required to comply with Section 11B-902. See Section 11B-227.

11B-226.2 Dispersion. Dining surfaces required to comply with Section 11B-902 shall be dispersed throughout the space or facility containing dining surfaces for each type of seating in a functional area. Work surfaces required to comply with Section 11B-902 shall be dispersed throughout the space or facility containing work surfaces.

11B-226.3 Dining Surfaces Exceeding 34 inches in Height. Where food or drink is served for consumption at a counter exceeding 34 inches in height, a portion of the main counter 60 inches minimum in length shall be provided in compliance with Section 11B-902.3.

11B-226.4 Baby Changing Tables. Baby changing tables shall comply with Sections 11B-309 and 11B-902. Baby changing tables when deployed shall not obstruct the required width of an accessible route except as allowed by Section 11B-307.2. Baby changing tables shall not be located in toilet compartments complying with Section 11B-604.8 within a multiple accommodation toilet facility.

11B-227 Sales & Service

11B-227.1 General. Where provided, check-out aisles, sales counters, service counters, food service lines, queues, and waiting lines shall comply with Sections 11B-227 and 11B-904.

11B-227.2 Check-Out Aisles. Not Applicable.

11B-227.3 Counters. Where provided, at least one of each type of sales counter and service counter shall comply with Section 11B-904.4. Where counters are dispersed throughout the building or facility, counters complying with Section 11B-904.4 also shall be dispersed.

11B-227.4 Food Service Lines. Food service lines shall comply with Section 11B-904.5. Where self-service shelves are provided, at least 50 percent, but no fewer than one, of each type provided shall comply with Section 11B-308.

11B-227.5 Queues & Waiting Lines. Queues and waiting lines servicing counters required to comply with Section 11B-904.3 or 11B-904.4 shall comply with Section 11B-403.

11B-228 Depositories, Vending Machines, Change Machines, Mail Boxes, Fuel Dispensers & Electric Vehicle Charging Stations

11B-228.1 General. Where provided, electric vehicle charging stations shall comply with Section 11B-228.3.

11B-228.2 Mail Boxes. Not Applicable.

11B-228.3 Electric Vehicle Charging Stations

11B-228.3.1 General. Where electric vehicle charging stations (EVCS) are provided, EVCS shall be provided in accordance with Section 11B-228.3.

11B-228.3.1.1 Existing Facilities. Where new EVCS are added to a facility with existing EVCS, the requirements of Section 11B-812 shall apply only to the new EVCS installed. Alterations to existing EVCS shall comply with Section 11B-228.3.

11B-228.3.1.2 Operable Parts. Where EV chargers are provided, operable parts on all EV chargers shall comply with Section 11B-309.4.

11B-228.3.2 Minimum Number. EVCS complying with Section 11B-812 shall be provided in accordance with Section 11B-228.3.2. Where EVCS are provided in more than one facility on a site, the number of EVCS complying with Section 11B-228.3.2 provided on the site shall be calculated according to the number required for each facility. Where an EV charger can simultaneously charge more than one vehicle, the number of EV chargers provided shall be considered equivalent to the number of electric vehicles that can be simultaneously charged.

11B-228.3.2.1 Public Use EVCS. Where EVCS are provided for public use, EVCS complying with Section 11B-812 shall be provided in accordance with Table 11B-228.3.2.1. Where new EVCS are installed in facilities with existing EVCS, the "Total Number of EVCS at a Facility" in Table 11B-228.3.2.1 shall include both existing and new EVCS.

Exception: All drive-up EVCS shall comply with Section 11B-812.

Total Number of EVCS at a Facility ¹	Minimum Number (by type) of EVCS Required to Comply with Section 11B-812	Van Accessible	Standard Accessible	Ambulatory
1 to 4	1	0	0	0
5 to 25	1	1	1	0
26 to 50	1	1	1	1
51 to 75	1	2	2	2
76 to 100	1	3	3	3
101 and over	1, plus 1 for each 300, or fraction thereof, over 100	3, plus 1 for each 60, or fraction thereof, over 100	3, plus 1 for each 50, or fraction thereof, over 100	

Note: Where an EV charger can simultaneously charge more than one vehicle, the number of EVCS provided shall be considered equivalent to the number of electric vehicles that can be simultaneously charged.

11B-229 Windows

11B-229.1 General. Where glazed openings are provided in accessible rooms or spaces for operation by occupants, at least one opening shall comply with Section 11B-309. Each glazed opening required by an administrative authority to be operable shall comply with Section 11B-309.

11B-230 Two-way Communication Systems

11B-230.1 General. Where a two-way communication system is provided to gain admittance to a building or facility or to restricted areas within a building or facility, the system shall comply with Section 11B-708.

11B-231 Judicial Facilities Not Applicable.

11B-232 Detention Facilities & Correctional Facilities Not Applicable.

11B-233 Residential Facilities Not Applicable.

11B-234 Amusement Rides Not Applicable.

11B-235 Recreational Boating Facilities Not Applicable.

11B-236 Exercise Machines & Equipment Not Applicable.

11B-237 Fishing Piers & Platforms Not Applicable.

11B-238 Golf Facilities Not Applicable.

11B-239 Miniature Golf Facilities Not Applicable.

11B-240 Play Areas Not Applicable.

11B-241 Saunas & Steam Rooms Not Applicable.

11B-242 Swimming Pools, Wading Pools & Spas Not Applicable.

11B-243 Shooting Facilities with Firing Positions Not Applicable.

11B-244 Religious Facilities Not Applicable.

11B-245 Public Accommodations Located in Private Residences Not Applicable.

11B-246 Outdoor Developed Areas Not Applicable.

11B-247 Detectable Warnings & Detectable Directional Texture

11B-247.1 Detectable Warnings

11B-247.1.1 General. Detectable warnings shall be provided in accordance with Section 11B-247.1 and shall comply with Section 11B-705.1.

11B-247.1.2 Where required. Detectable warnings shall be provided where required by Section 11B-247.1.2.

11B-247.1.2.1 Platform Edges. Not Applicable.

11B-247.1.2.2 Curb Ramps. Curb ramps shall have detectable warnings complying with Sections 11B-705.1.1 and 11B-705.1.2.2.

11B-247.1.2.3 Islands or Cut-Through Medians. Islands or cut-through medians shall have detectable warnings complying with Sections 11B-705.1.1 and 11B-705.1.2.3.

11B-247.1.2.4 Bus stops. Not Applicable.

11B-247.1.2.5 Hazardous Vehicular Areas. If a walk crosses or adjoins a vehicular way, and the walking surfaces are not separated by curbs, railings or other elements between the pedestrian areas and vehicular areas, the boundary between the areas shall be defined by a continuous detectable warning complying with Sections 11B-705.1.1 and 11B-705.1.2.5.

11B-247.1.2.6 Reflecting Pools. Not Applicable.

11B-247.1.2.7 Track crossings. Not Applicable.

11B-247.2 Detectable Directional Texture. Not Applicable.

DIVISION 3: BUILDING BLOCKS

11B-301 General

11B-301.1 Scope. The provisions of Division 3 shall apply where required by Division 2 or where referenced by a requirement in this chapter.

11B-302 Floor or Ground Surfaces

11B-302.1 General. Floor and ground surfaces shall be stable, firm, and slip resistant and shall comply with Section 11B-302.



Figure 11B-302.2 Carpet Pile Height

11B-302.3 Openings. Openings in floor or ground surfaces shall not allow passage of a sphere more than 1/2 inch diameter except as allowed in Sections 11B-407.4.3, 11B-409.4.3, 11B-410.4, 11B-810.5.3 and 11B-810.10. Elongated openings shall be placed so that the long dimension is perpendicular to the dominant direction of travel.

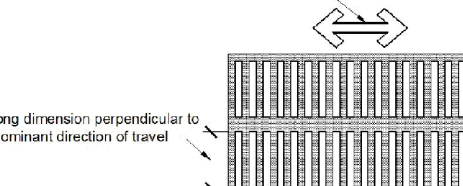

Figure 11B-302.3 Elongated Openings in Floor or Ground Surfaces

11B-303 Changes in Level

11B-303.1 General. Where changes in level are permitted in floor or ground surfaces, they shall comply with Section 11B-303.

11B-303.2 Vertical. Changes in level of 1/2 inch high maximum shall be permitted to be vertical and 1/4 inch maximum shall be beveled.

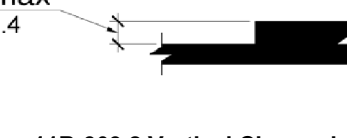

Figure 11B-303.2 Vertical Change in Level

11B-303.3 Beveled. Changes in level between 1/4 inch (6.4 mm) high minimum and 1/2 inch (12.7 mm) high maximum shall be beveled with a slope not steeper than 1:2.

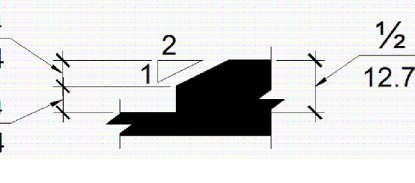

Figure 11B-303.3 Beveled

11B-303.2 Vertical Change in Level

11B-303.3 Beveled. Changes in level between 1/4 inch (6.4 mm) high minimum and 1/2 inch (12.7 mm) high maximum shall be beveled with a slope not steeper than 1:2.

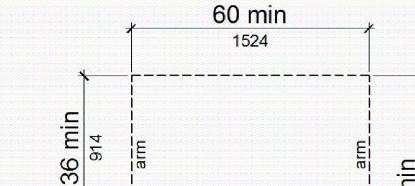

Figure 11B-303.2 Vertical Change in Level

11B-303.3 Beveled. Changes in level between 1/4 inch (6.4 mm) high minimum and 1/2 inch (12.7 mm) high maximum shall be beveled with a slope not steeper than 1:2.

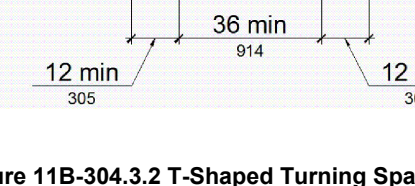

Figure 11B-303.3 Beveled

11B-304 Door Swing. Doors shall be permitted to swing into turning spaces.

11B-305 Clear Floor or Ground Space

11B-305.1 General. Clear floor or ground space shall comply with Section 11B-305.

11B-305.2 Floor or Ground Surfaces. Floor or ground surfaces of a clear floor or ground space shall comply with Section 11B-302. Changes in level are not permitted.

Exception: Slopes not steeper than 1:48 shall be permitted.

11B-305.3 Size. The clear floor or ground space shall be 30 inches minimum by 48 inches minimum.

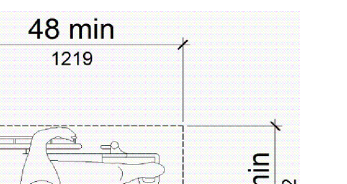

Figure 11B-305.3 Clear Floor or Ground Space

11B-305.4 Knee & Toe Clearance. Unless otherwise specified, clear floor or ground space shall be permitted to include knee and toe clearance complying with Section 11B-306.

11B-305.5 Position. Unless otherwise specified, clear floor or ground space shall be positioned for either forward or parallel approach to an element.

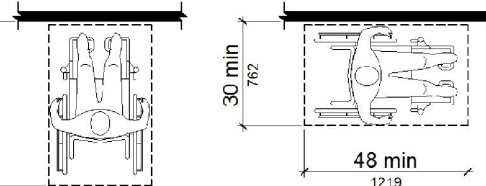

Figure 11B-305.5 Position of Clear Floor or Ground Space

11B-305.6 Approach. One full unobstructed side of the clear floor or ground space shall adjoin an accessible route or adjoin another clear floor or ground space. Clear floor or ground space may overlap an accessible route, unless specifically prohibited elsewhere in this chapter.

11B-305.7 Maneuvering Clearance. Where a clear floor or ground space is located in an alcove or otherwise confined on all or part of three sides, additional maneuvering clearance shall be provided in accordance with Sections 11B-305.7.1 and 11B-305.7.2.

11B-305.7.1 Forward Approach. Alcoves shall be 36 inches wide minimum where the depth exceeds 24 inches.

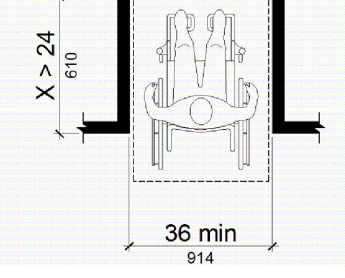

Figure 11B-305.7.1 Maneuvering Clearance in an Alcove, Forward Approach

11B-305.7.2 Parallel Approach. Alcoves shall be 60 inches wide minimum where the depth exceeds 15 inches.

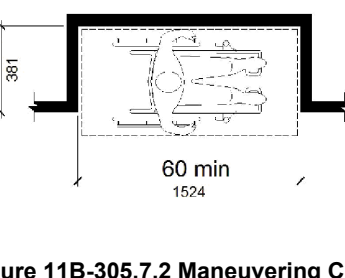

Figure 11B-305.7.2 Maneuvering Clearance in an Alcove, Parallel Approach

11B-306 Knee & Toe Clearance

11B-306.1 General. Where space beneath an element is included as part of clear floor or ground space or turning space, the space shall comply with Section 11B-306. Additional space shall not be prohibited beneath an element but shall not be considered as part of the clear floor or ground space or turning space.

11B-306.2 Toe Clearance

11B-306.2.1 General. Space under an element between the finish floor or ground and 9 inches above the finish floor or ground shall be considered toe clearance and shall comply with Section 11B-306.2.

11B-306.2.2 Maximum Depth. Toe clearance shall extend 25 inches maximum under an element.

Exception: Toe clearance shall extend 19 inches maximum under lavatories required to be accessible by Section 11B-213.3.4.

11B-306.2.3 Minimum Required Depth. Where toe clearance is required at an element as part of a clear floor space, the toe clearance shall extend 17 inches minimum under the element.

Exceptions:
1. The toe clearance shall extend 19 inches minimum under sinks required to be accessible by Section 11B-212.3.
2. The toe clearance shall extend 19 inches minimum under built-in dining and work surfaces required to be accessible by Section 11B-226.1.

11B-306.2.4 Additional Clearance. Space extending greater than 6 inches beyond the available knee clearance at 9 inches above the finish floor or ground shall not be considered toe clearance.

11B-306.2.5 Width. Toe clearance shall be 30 inches wide minimum.

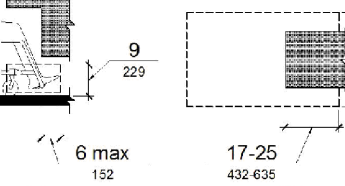

Figure 11B-306.2 Toe Clearance

11B-306.3 Knee Clearance

11B-306.3.1 General. Space under an element between 9 inches and 27 inches above the finish floor or ground shall be considered knee clearance and shall comply with Section 11B-306.3.

Exception: At lavatories required to be accessible by Section 11B-213.3.4, space between 9 inches and 29 inches above the finish floor or ground, shall be considered knee clearance.

11B-306.3.2 Maximum Depth. Knee clearance shall extend 25 inches maximum under an element at 9 inches above the finish floor or ground.

11B-306.3.3 Minimum Required Depth. Where knee clearance is required under an element as part of a clear floor space, the knee clearance shall be 11 inches deep minimum at 9 inches above the finish floor or ground, and 8 inches deep minimum at 27 inches above the finish floor or ground.

Exceptions:
1. At lavatories required to be accessible by Section 11B-213.3.4, the knee clearance shall be 27 inches high minimum above the finish floor or ground at a depth of 8 inches minimum increasing to 29 inches high minimum above the finish floor or ground at the front edge of a counter with a built-in lavatory or at the front edge of a wall-mounted lavatory fixture.
2. At dining and work surfaces required to be accessible by Section 11B-226.1, knee clearance shall extend 19 inches deep minimum at 27 inches above the finish floor or ground.

11B-306.3.4 Clearance Reduction. Between 9 inches and 27 inches above the finish floor or ground, the knee clearance shall be permitted to reduce at a rate of 1 inch in depth for each 6 inches in height.

Exception: The knee clearance shall not be reduced at built-in dining and work surfaces required to be accessible by Section 11B-226.1.

11B-306.3.5 Width. Knee clearance shall be 30 inches wide minimum.

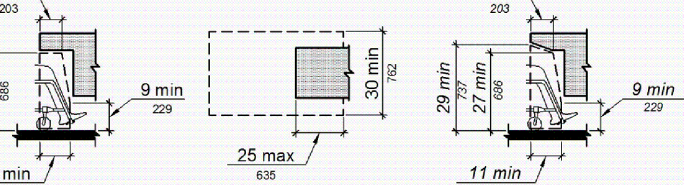

Figure 11B-306.3 Knee Clearance

11B-306.3.4 Clearance Reduction. Between 9 inches and 27 inches above the finish floor or ground, the knee clearance shall be permitted to reduce at a rate of 1 inch in depth for each 6 inches in height.

Exception: The knee clearance shall not be reduced at built-in dining and work surfaces required to be accessible by Section 11B-226.1.

11B-306.3.5 Width. Knee clearance shall be 30 inches wide minimum.

11B-307 Protruding Objects

11B-307.1 General. Protruding objects shall comply with Section 11B-307.

11B-307.2 Protrusion Limits. Objects with leading edges more than 27 inches and not more than 80 inches above the finish floor or ground shall protrude 4 inches maximum horizontally into the circulation path.

Exception: Handrails shall be permitted to protrude 4 1/4 inches (114 mm) maximum.

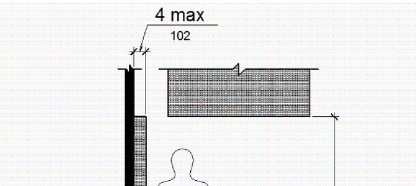

Figure 11B-307.2 Limits of Protruding Objects

11B-307.3 Post-Mounted Objects. Free-standing objects mounted on posts or pylons shall overhang circulation paths 12 inches maximum when located 27 inches minimum and 80 inches maximum above the finish floor or ground. Where a sign or other obstruction is mounted between posts or pylons and the clear distance between the posts or pylons is greater than 12 inches, the lowest edge of such sign or obstruction shall be 27 inches maximum or 80 inches minimum above finish floor or ground.

Exception: The sloping portions of handrails serving stairs and ramps shall not be required to comply with Section 11B-307.3.

11B-307.3.1 Edges & Corners. Where signs or other objects are mounted on posts or pylons, and their bottom edges are less than 80 inches above the floor or ground surface, the edges of such signs and objects shall be rounded or eased and the corners shall have a minimum radius of 1/8 inch.

REVISIONS	
DATE	DESCRIPTION

Bid Issue Date: TBD
Date: 10/23/24
Scale: AS NOTED
Project No.:
Sheet Title:

ACCESSIBILITY NOTES

Sheet No.:

T1.2

FINISH GENERAL NOTES

GENERAL

- GENERAL CONTRACTOR TO SUBMIT TO TENANT AND DESIGNER FINISH SAMPLES, PRODUCT DATA SHEETS INCLUDING BUT NOT LIMITED TO: PREPARATION INSTRUCTIONS, AND RECOMMENDATIONS, STORAGE AND HANDLING REQUIREMENTS, INSTALLATION METHODS, MAINTENANCE REQUIREMENTS, FOR APPROVAL PRIOR TO INSTALLATION.
- GENERAL CONTRACTOR TO VERIFY PATTERNS AND LAYOUT PRIOR TO INSTALLATION.
- CONTRACTORS ARE TO PROTECT ALL PROPERTY AND THE WORK OF ALL OTHER TRADES AGAINST DAMAGE OR INJURY CAUSED BY THEIR ACTIVITY AND THE ACTIVITY OF THE SUBCONTRACTOR.
- THE SUBCONTRACTORS ARE CONSIDERED TO BE EXPERTS IN THEIR RESPECTIVE FIELDS AND SHALL NOTIFY THE TENANT AND DESIGNER IMMEDIATELY OF ANY WORK DESIGNED BY THE DESIGNER WHICH CANNOT BE FULLY COMPLIED WITH OR GUARANTEED PRIOR TO THE INSTALLATION OF THE WORK.
- ALL INTERIOR FINISHES/MATERIALS AND WORKMANSHIP, SHALL CONFORM TO TO MEET/COMPLY WITH REQUIREMENTS OUTLINED IN TABLE 803.9 AND SEC. 804 OF CH.8 CBC 2016 IN ADDITION TO THE REQUIREMENTS OF LOCAL CODES, LAWS, ORDINANCES IN EFFECT DURING THIS PROJECT.
- NO EXCEPTIONS ON ALL PAINT AND FINISHES, ANY MODIFICATION TO BE SUBMITTED TO DESIGNER FOR REVIEW AND APPROVAL.

GYPSTUM BOARD

- INTERIOR GYPSUM BOARD SHALL COMPLY WITH ASTM C36/C 36M OR ASTM C 1396/C 1396M, IN THICKNESS INDICATED AND WITH MANUFACTURE'S STANDARD EDGES.
- GLASS MAT WATER RESISTANT GYPSUM BACKING BOARD SHALL COMPLY WITH ASTM C 1178/C 1178 M, OF THICKNESS INDICATED. MATERIAL SHALL BE DENS SHIELD OR APPROVED EQUAL.
- PROVIDE ALL TRIM ACCESSORIES SUCH AS CORNER BEAD, ETC. TRIM ACCESSORIES SHALL MEET ASTM C 1047, FORMED FROM GALVANIZED STEEL SHEET.
- JOINT TREATMENT MATERIALS SHALL MEET ASTM C 475/C 475 M. JOINT TAPE SHALL BE PAPER. JOINT COMPOUND SHALL BE READY MIXED, ALL PURPOSE COMPOUNDS. THE FINAL COAT OF LEVEL 5 FINISH USE SETTING TYPE, SANDABLE TOPING COMPOUND DESIGNED FOR APPLICATION BY AIRLESS SPRAYER AND TO USE INSTEAD OF SKIM COAT TO PRODUCE A LEVEL 4 FINISH.
- GYPSUM BOARD USED WITHIN THE PROJECT SPACES SHALL BE 5/8" TYPE 'X' FIRE SHIELD GYPSUM BOARD GOLD BOND AS MANUFACTURED BY NATIONAL GYPSUM COMPANY OR EQUAL.
- ALL GYPSUM BOARD SHALL BE INSTALLED USING APPROPRIATE TYPE AND SIZE SCREW TO INSURE SOLID INSTALLATION.
- ALL JOINT TAPE AND COMPOUNDS SHALL BE PROFORM BRAND AS MANUFACTURED BY NATIONAL GYPSUM COMPANY OR EQUAL.
- INSTALL ALL GYPSUM BOARD PER THE MANUFACTURES SPECIFICATIONS.
- ALL GYPSUM BOARD WALL AND CEILINGS SHALL RECEIVE A LEVEL 4 FINISH UNLESS NOTED OTHERWISE.
- WHERE INDICATED ON THE INTERIOR DRAWINGS TO INSTALL WALL COVERING THE CONTRACTOR SHALL PREP WALL TO ACCEPT THE WALL COVERING. THIS MAY REQUIRE A SKIM COAT OVER THE WALL SURFACE AND IS CONSIDERED PART OF THE CONTRACTOR'S SCOPE OF WORK.
- CONTRACTOR SHALL BE RESPONSIBLE FOR ANY NEW PATCH BACK AND TEXTURING OF THE GYPSUM BOARD OF THIS PROJECT SO THAT ALL WALLS AND CEILINGS ARE UNIFORM AND DONE IN A PROFESSIONAL MANNER. IF OTHER WORK OR TRADES REQUIRE DEMOLITION OR DAMAGE TO EXISTING GYPSUM BOARD THAT IS NOT SHOWN ON THESE DRAWINGS THE CONTRACTOR SHALL UNDERSTAND THE WORK REQUIRED BY THEIR SUB CONTRACTORS AND BE RESPONSIBLE FOR ALL PATCH BACK AND REPAIR OF THE GYPSUM BOARD AND TEXTURE.

STONE AND TILE

- REFER TO FINISH SCHEDULE NOTES FOR ADDITIONAL INFORMATION.
- SETTING AND GROUTING MATERIALS SHALL COMPLY WITH MATERIAL STANDARDS ANSI'S "SPECIFICATIONS FOR THE INSTALLATION OF CERAMIC TILE": THAT APPLY TO MATERIALS AND METHOD INDICATED.
- GROUT SHALL BE PER THE INTERIOR SPECIFICATIONS.
- ALL STONE AND TILE FLOORING TO BE SEALED SO THAT THE SURFACE MEETS THE MINIMUM INDUSTRY STANDARD FOR SLIP RESISTANCE. MATERIAL SHALL BE COLORLESS AND NOT AFFECT THE COLOR OR PHYSICAL PROPERTIES OF THE STONE OR TILE SURFACE.
- COMPLY WITH TCAS "HANDBOOK FOR THE CERAMIC INSTALLATION" FOR TCA INSTALLATION METHODS SPECIFIED IN TILE INSTALLATION SCHEDULES. COMPLY WITH PARTS OF ANSI A108 SERIES "SPECIFICATIONS FOR INSTALLATION OF CERAMIC TILE" THAT ARE REFERENCED IN TCA INSTALLATION METHODS, SPECIFIED IN TILE INSTALLATION SCHEDULES, AND APPLY TO TYPES OF SETTING AND GROUTING MATERIALS USED.
- FOR TILE FLOORS, FOLLOW PROCEDURES IN ANSI A108 FOR PROVIDING 95 PERCENT MORTOR COVERAGE.
- PERFORM CUTTING AND DRILLING OF TILE WITHOUT MARRING VISIBLE SURFACES. CAREFULLY GRIND CUT EDGES OF TILE ABUTTING TRIM, FINISH, OR BUILT-IN ITEMS FOR STRAIGHT ALIGNED JOINTS, FIT CLOSELY TO ELECTRICAL OUTLETS, PIPING, FIXTURES, AND OTHER PENETRATIONS SO PLATES, COLLARS, OR COVERS OVERLAP TILE.
- INSTALL WATERPROOFING TO COMPLY WITH ANSI A108.13.
- DO NOT INSTALL TILE OVER WATERPROOFING UNTIL WATERPROOFING HAS CURED AND BEEN TESTED TO DETERMINE THAT IT IS WATERTIGHT.
- ALL TILE SURFACES TO BE SET FLUSH UNLESS OTHERWISE NOTED.
- SURFACE TO RECEIVE TILE SHALL BE DRY, CLEAN, FIRM, LEVEL AND PLUMB BEFORE WORK BEGINS.
- USE FULL TILES THROUGHTOUT, CUTTING ONLY WHERE NECESSARY AND APPROVED BY ARCHITECT. ANY CUTTING AND DRILLING TO BE DONE WITHOUT MARRING FACE OF TILE.
- AT COMPLETION OF WORK ALL TILE SHALL BE THOROUGHLY CLEANED, JOINTS REGROUTED WHERE REQUIRED AND ANY DEFECTIVE WORK REPLACED IN A MANNER SUITABLE TO ARCHITECT, AT NO ADDITIONAL COST TO THE OWNER.
- LAY TILE IN GRID PATTERN UNLESS OTHERWISE INDICATED. ALIGN JOINTS WHERE ADJOINING TILES ON FLOOR, BASE, WALLS, AND TRIM ARE THE SAME SIZE.
- INSTALL CEMENTITIOUS BACKER UNITS AND TREAT JOINTS ACCORDING TO ANSI A108.11.
- WHERE INDICATED, PREPARE SUBSTRATES TO RECEIVE WATERPROOFING BY APPLYING A REINFORCED MORTAR BED THAT COMPLIES WITH ANSI A108.1A AND IS SLOPED 1/4 INCH PER FOOT TOWARD DRAINS.
- INSTALL WATERPROOFING TO COMPLY WITH ANSI A108.13.
- INSTALL STONE THRESHOLDS IN SAME TYPE OF SETTING BED AS ADJACENT FLOOR UNLESS OTHERWISE INDICATED. AT LOCATIONS WHERE MORTAR BED (THICKSET) WOULD OTHERWISE BE EXPOSED ABOVE ADJACENT FLOOR FINISHES, SET THRESHOLDS IN LATEX-PORTLAND CEMENT MORTAR (THIN SET).
- APPLY SEALER TO CLEANED STONE TILE FLOORING ACCORDING TO SEALER MANUFACTURER'S WRITTEN INSTRUCTIONS.
- MINIMIZE GROUT LINES. REFER TO FINISH SCHEDULE.
- REFER TO DETAILS AND SPECS FOR HANGING AND SETTING DETAILS.
- SUBMIT 12"x12" STONE OR TILE FINISH SAMPLES FOR APPROVAL.
- PROVIDE DRY LAY-OUT FOR ALL STONE WALLS AND FLOORS. FOR REVIEW BY ARCHITECT AND OWNER.
- TILE AND GROUT SHALL BE AS SPECIFIED, ANY CHANGES IN THE TILE TO BE SUBMITTED TO DESIGNER FOR APPROVAL.
- ALL TILE SURFACES TO BE SET FLUSH UNLESS OTHERWISE NOTED.
- DO NOT START WORK UNTIL ALL ELECTRICAL AND OR MECHANICAL WORK IN OR BEHIND TILE HAS BEEN INSTALLED.
- ALL FLOORS TO BE EVEN AND LEVEL.
- ALL CONTROL JOINT AND METAL JOINT LOCATIONS DIFFERING FROM THOSE SHOWN IN THE CONTRACT DOCUMENTS TO BE COORDINATED WITH DESIGN AND MUST BE APPROVED IN ADVANCE OF ORDER/INSTALLATION BY ARCHITECT.

MILLWORK

- ALL DIMENSIONS AND CONDITIONS ON DRAWINGS TO BE VERIFIED IN RELATIONSHIP TO FINISHED CONSTRUCTION CONDITIONS BEFORE ANY WORK BEGINS.
- MILLWORKER TO PREPARE A COMPLETE SET OF SHOP DRAWINGS FOR REVIEW AND APPROVAL BY THE DESIGNER FOR CONFORMANCE TO DESIGN INTENT.
- MILLWORKER TO COORDINATE HIS WORK WITH THAT OF OTHER TRADES.
- SUBMIT TO DESIGNER FOR APPROVAL 12" X12" MIN. SAMPLES OF ALL MATERIALS SPECIFIED IN THE PRECISE FINISH SPECIFIED. SMALLER SIZED SAMPLES MAY BE SUFFICIENT FOR CERTAIN MATERIALS AND THE DESIGNER WILL MAKE THIS DETERMINATION ON A CASE BY CASE BASIS. WOOD GRAINING AND NATURAL VARIATIONS MUST BE EVIDENT IN THE SAMPLES SUBMITTED FOR APPROVAL.
- ALL MATERIALS SHALL BE FREE OF CHIPPING, ABRASIONS, DISTRESS, WARPING, CRACKING, FLAKING, SPLITTING, MOISTURE OR ANY MARRING THAT WOULD RESULT IN AN UNEVEN OR DAMAGED SURFACE.
- ALL CABINETWORK SHALL BE SHOP FINISHED. ASSEMBLE CABINETWORK FINISHED IN AS LARGE UNITS AS POSSIBLE AT MILL, READY FOR ERECTION. WHERE NECESSARY TO FIT AT PROJECT, MAKE ADEQUATE ALLOWANCE FOR CUTTING AND FITTING.
- AFTER COMPLETION OF ASSEMBLY AND FITTING, ALL FINISH NAIL HOLES, SCRATCHES AND OPEN JOINTS SHALL BE FILLED AND TOUCHED UP SO AS TO BE INVISIBLE.
- ALL EXPOSED EDGES TO BE FINISHED, TYPICAL.
- ALL FIXTURES FROM ALL TRADES AND THEIR RESPECTIVE REQUIREMENTS (WIRE CHASES, VENTILATION, DRAINAGE, ACCESS PANELS, ADJACENT FINISHES, ATTACHMENT BLOCKING, STRUCTURAL REINFORCEMENT, ETC.) MUST BE SHOWN TO SCALE AND BE FULLY COORDINATED IN THE SHOP DRAWINGS
- ALL TRIMS, DRAWER FRONTS, COUNTER TOPS TO BE SOLID STOCK. NO EXPOSED PLYWOOD ENDS OR TAPE. ALL EXPOSED EDGES TO BE FINISHED WITH SOLID WOOD PROFILE, TYPICAL.
- USE PREMIUM FURNITURE GRADE FINISH WOOD FOR BUILT-IN MILLWORK EXPOSED FACE/FRONT PANELS. USE PREMIUM GRADE FINISH LUMBER FREE OF KNOTS, DEFECTS, CRACKS ETC. FOR ALL MILLWORK FRAMES U.O.N.
- ALL MILLWORK SUBJECT TO APPROVAL OF SHOP DRAWING AND FINISHED MATERIAL SAMPLES BY OWNER AND ARCHITECT.
- G.C. TO PROVIDE IN-WALL BLOCKING AND ANY NECESSARY STRUCTURAL FRAMING FOR BUILT-IN MILLWORK.
- ALL NEW MILLWORK TRIM PROFILES (BASE, DOOR FRAME, CASED OPENINGS, CROWN & CORNICE MOLDINGS, AND PICTURE RAILS) TO MATCH EXISTING U.O.N. ANY NEW MILLWORK TRIM DETAILS INCLUDED IN THE DRAWINGS SUPERSEDE EXISTING MOLDINGS AND TRIMS - FOLLOW DRAWING DETAILS AND SPECIFICATIONS AS REQUIRED.
- FOREST CERTIFICATION: PROVIDE WOODWORK PRODUCED FROM WOOD OBTAINED FROM FORESTS CERTIFIED BY AN FSC ACCREDITED CERTIFICATION BODY TO COMPLY WITH FSC STD 01-001, "FSC PRINCIPLES AND CRITERIA FOR FOREST STEWARDSHIP.
- DO NOT DELIVER OR INSTALL WOODWORK UNTIL BUILDING IS ENCLOSED, WET WORK IS COMPLETED, AND HVAC SYSTEM IS OPERATING.
- BEFORE INSTALLATION, CONDITION WOODWORK TO AVERAGE PREVAILING HUMIDITY CONDITIONS IN INSTALLATION AREAS.
- INSTALL WOODWORK TO COMPLY WITH REFERENCED QUALITY STANDARD FOR GRADE SPECIFIED.
- INSTALL WOODWORK LEVEL, PLUMB, TRUE, AND STRAIGHT. SHIM AS REQUIRED WITH CONCEALED SHIMS. INSTALL LEVEL AND PLUMB (INCLUDING TOPS) TO A TOLERANCE OF .
- SCRIBE AND CUT WOODWORK TO FIT ADJOINING WORK, REFINISH CUT SURFACES, AND REPAIR DAMAGED FINISH AT CUTS.
- ANCHOR WOODWORK TO ANCHORS OR BLOCKING BUILT IN OR DIRECTLY ATTACHED TO SUBSTRATES. FASTEN WITH COUNTERSUNK CONCEALED FASTENERS AND BLIND NAILING. USE FINE FINISHING NAILS FOR EXPOSED NAILING, COUNTERSUNK AND FILLED FLUSH WITH WOODWORK.
- STANDING AND RUNNING TRIM: INSTALL WITH MINIMUM NUMBER OF JOINTS POSSIBLE, USING FULL-LENGTH PIECES (FROM MAXIMUM LENGTH OF LUMBER AVAILABLE) TO GREATEST EXTENT POSSIBLE. DO NOT USE PIECES LESS THAN 36 INCHES LONG, EXCEPT WHERE SHORTER SINGLE-LENGTH PIECES ARE NECESSARY. SCARF RUNNING JOINTS AND STAGGER IN ADJACENT AND RELATED MEMBERS.

WOOD TRIM WORK

- ALL NEW WOOD TRIM SHALL BE CAULKED IN A PROFESSIONAL MANNER TO THE ADJACENT SURFACE. CAULK COLOR TO MATCH ADJACENT MATERIAL COLOR. PROVIDE SAMPLE FOR APPROVAL.
- ALL EXISTING AND NEW BASEBOARDS SHALL BE PREPPED AND PAINTED PER INTERIOR DRAWINGS. HOLES, CRACKS, AND ANY DEFORMITIES SHALL BE REPAIRED BEFORE PAINTING.
- ALL EXISTING AND NEW DOOR JAMBS, CASINGS, AND CASED OPEINGS SHALL BE PREPPED AND PAINTED PER INTERIOR DRAWINGS. HOLES, CRACKS, AND ANY DEFORMITIES SHALL BE REPAIRED BEFORE PAINTING.

WALLCOVERING

- REFER TO INTERIOR SPECIFICATIONS FOR ALL WALLCOVERINGS.
- ADHESIVE TO BE MILDEW RESISTANT NON-STAINING ADHESIVE FOR USE WITH SPECIFIC WALL COVERING AND SUBSTRATE APPLICATION, AS RECOMMENDED IN WRITING BY THE WALLCOVERING MANUFACTURER, PROVIDE MILDEW RESISTANT PRIMER/SEALER RECOMMENDED IN WRITING BY WALL COVERING MANUFACTURER FOR INTENDED SUBSTRATE.
- INSTALL SEAMS VERTICAL AND PLUMB, WITH NO HORIZONTAL SEAMS.
- REMOVE EXCESS ADHESIVE AT FINISHED SEAMS, PERIMETER EDGES, AND ADJACENT SURFACES USING CLEANING METHODS RECOMMENDED BY THE WALL COVERING MANUFACTURER, REPLACE STRIPS THAT CANNOT BE CLEANED.

PAINTING

- ALL PAINT COLORS SHALL BE PER THE INTERIOR SPECIFICATIONS.
- PROVIDE DRAW DOWNS AND MOCK UP FOR REVIEW AND APPROVAL.
- MANUFACTURE OF PAINT MATERIALS SHALL BE PER THE FINISH SCHEDULE.
- ALL PAINT SHALL BE APPLIED PER THE MANUFACTURER'S INSTALLATIONS INSTRUCTIONS. EACH COAT SHALL BE THE MINIMUM THICKNESS PER THE MANUFACTURER'S RECOMMENDATIONS.
- APPLY PAINTS TO PRODUCE SURFACE FILMS WITHOUT CLOUDINESS, SPOTTING, HOLIDAYS, LAPS, BRUSH MARKS, ROLLER TRACKING, RUNS, SAGS, ROPINESS, OR OTHER SURFACE IMPERFECTIONS. CUT IN SHARP LINES AND COLOR BREAKS.
- ALL ITEMS SHOWN ON THE DRAWINGS TO BE PAINTED SHALL RECEIVE PROPER PREP AND PATCH TO RECEIVE NEW PRIMER AND PAINT. PREP SHALL INCLUDE THE FILLING OF ANY HOLES, CRACKS, OR OTHER IMPERFECTIONS SO THE SURFACE AREA BEING PAINTED IS CONSISTENT THROUGHOUT. DO NOT BEGIN PAINTING UNTIL SUBSTRATES HAVE BEEN PROPERLY PREPARED.
- ALL AREAS TO BE PAINTED SHALL RECEIVE TWO COATS OVER ONE COAT PRIMER. COAT THICKNESS SHALL BE MINIMUM REQUIRED BY PAINT MANUFACTURER BEING USED. REGARDLESS OF NUMBER OF COATS SPECIFIED CONTRACTOR SHALL APPLY AS MANY COATS AS NECESSARY FOR COMPLETE HIDE, COAT THICKNESS, AND UNIFORM APPEARANCE. UNIFORMLY APPLY PAINT WITHOUT RUNS, DRIPS, OR SAGS, WITHOUT BRUSH MARKS, AND WITH CONSISTENT SHEEN. CONTRACTOR SHALL PROVIDE DRAW DOWNS AND CUT SHEETS OF PAINT MATERIALS BEING USED. REFER TO FINISH SCHEDULES FOR PAINT COLORS AND MANUFACTURER'S.
- CONTRACTOR SHALL REMOVE ALL SPILLED, SPLASHED, SPATTERED OR OVER SPRAYED PAINT AS WORK PROGRESSES, REMOVE WASTE MATERIALS PER LOCAL CODES.
- PAINTING SHALL NOT BE DONE IN A MAINTAINED ENVIRONMENTAL CONDITION (TEMPERATURE, HUMIDITY, AND VENTILATION) WITHIN LIMITS RECOMMENDED BY MANUFACTURER FOR OPTIMUM RESULTS. DO NOT APPLY COATINGS UNDER ENVIRONMENTAL CONDITIONS OUTSIDE MANUFACTURER'S ABSOLUTE LIMITS.
- PAINT SHALL BE FACTORY MIXED AND BE CATEGORIZED AS "BEST" BY THE MANUFACTURER FOR THE SUBSTRATE THE PAINT IS BEING APPLIED. USE PRIMERS AS CATEGORIZED AS "BEST" BY THE MANUFACTURER FOR THE SUBSTRATE THE PRIMER IS BEING APPLIED. DO NOT REDUCE, THIN, OR DILUTE COATINGS OR ADD MATERIALS TO COATING UNLESS SUCH PROCEDURE IS SPECIFICALLY DESCRIBED IN MANUFACTURER'S PRODUCT INSTRUCTIONS.
- PROVIDE 3-COLOR TREATMENT AT EACH SURFACE, U.O.N.
- SCRAPE, PATCH AND SAND SMOOTH ALL SURFACES TO BE REPAINTED.
- PROVIDE TEMPORARY PAINT PROOF PROTECTION TO PREVENT THE SPREAD OF PAINT TO EXISTING LOCATIONS.
- BEFORE PAINTING BEGINS, AREA IS TO BE FREE OF DEBRIS AND AIRBORNE POLLUTANTS WHICH WILL AFFECT FINISH.
- NO MATERIALS OTHER THAN THOSE APPROVED OR SPECIFIED MAY BE DELIVERED TO OR ACCEPTED AT THE PROJECT SITE.
- BEFORE BEGINNING ANY WORK, THE PAINTING SUBCONTRACTOR SHALL INSPECT ALL SURFACES TO BE PAINTED OR FINISHED. HE SHALL NOTIFY THE CONTRACTOR IN WRITING OF ANY UNSUITABLE CONDITIONS. NO PAINTING SHALL COMMENCE UNLESS THE SUBSURFACE IS IMMACULATLY PREPARED.
- THE PRIME COAT ON ALL SURFACES TO APPROXIMATE THE COLOR OF THE FINISHED SURFACE.
- ALL PAINTED SURFACES TO RECEIVE TWO (2) COATS OF FINISH PAINT MINIMUM.
- FINISHED SURFACES TO BE PERFECTLY SMOOTH AND EVENLY FINISHED THROUGHOUT PROJECT.
- AT COMPLETION OF WORK ANY DAMAGED SURFACES TO BE PATCHED WHERE REQUIRED AND REPAINTED.

RESINOUS FLOORING

- PROVIDE PREPARATION OF SUBSTRATE AS RECOMMENDED BY THE RESINOUS FLOORING MANUFACTURER.
- TEST HORIZONTAL SUBSTRATES TO DETERMINE ACCEPTABLE DRYNESS. TEST METHOD AS RECOMMENDED BY RESINOUS FLOORING MANUFACTURER.
- PROVIDE AND INSTALL COVE BASE WITH TRIMS AND ACCESSORIES AS RECOMMENDED BY MANUFACTURER AND PER PLANS.
- SUBMIT, FOR VERIFICATION PURPOSES, 3-5 INCH SQUARE SAMPLES OF EACH TYPE OF OF RESINOUS FLOORING REQUIRED, APPLIED TO RIGID BACKING, IN COLOR AND FINISH INDICATED.
- SUBMIT MANUFACTURER'S WRITTEN INSTRUCTIONS FOR RECOMMENDED MAINTENANCE PRACTICES.
- OBTAIN PRIMARY RESINOUS FLOORING MATERIALS INCLUDING PRIMERS, GROUTS, RESINS, HARDENING AGENTS, FINISH OR SEALING COATS FROM A SINGLE MANUFACTURER WITH NOT LESS THAN TEN YEARS OF SUCCESSFUL EXPERIENCE IN MANUFACTURING AND INSTALLING PRINCIPAL MATERIALS DESCRIBED IN THIS SECTION.
- USE MATERIALS FOR WORK OF THIS SECTION WHICH COMPLY WITH VOLATILE ORGANIC COMPOUNDS LIMITATIONS AND OTHER REGULATIONS OF LOCAL AIR QUALITY MANAGEMENT DISTRICT AND OTHER LOCAL, STATE, AND FEDERAL AGENCIES HAVING JURISDICTION.
- APPLY EACH COMPONENT OF RESINOUS FLOORING SYSTEM IN COMPLIANCE WITH MANUFACTURER'S WRITTEN DIRECTIONS TO PRODUCE A UNIFORM, MONOLITHIC WEARING SURFACE OF THICKNESS INDICATED, UNINTERRUPTED EXCEPT AT DIVIDER STRIPS, SAWN JOINT OR OTHER TYPES OF JOINTS (IF ANY), INDICATED OR REQUIRED.
- JOB ARE TO BE FREE OF OTHER TRADES DURING, AND FOR A PERIOD OF AT LEAST 24 HOURS, AFTER FLOOR INSTALLATION.
- PROTECTION OF FINISHED FLOOR FROM DAMAGE BY SUBSEQUENT TRADES SHALL BE THE RESPONSIBILITY OF THE GENERAL CONTRACTOR.
- APPLY FINISH SEALER AT A RATE TO ACHIEVE A SURFACE FINISH THAT MATCHES SAMPLES SUBMITTED AND APPROVED.

CONCRETE STAIN

- ALL MATERIALS USED AS THE STAINED CONCRETE FLOOR SYSTEM SHALL BE MANUFACTURED AND PROVIDED BY A SINGLE MANUFACTURER TO ENSURE COMPATIBILITY AND PROPER BONDING.
- PREPARE SURFACES USING METHODS RECOMMENDED BY THE MANUFACTURER FOR ACHIEVING THE BEST RESULT FOR THE SUBSTRATE UNDER THE PROJECT CONDITIONS.
- INSTALL COATINGS IN ACCORDANCE WITH MANUFACTURER'S WRITTEN INSTRUCTIONS.
- UNIFORMLY APPLY COATINGS AT SPREAD RATES AND IN NUMBER OF COATS TO ACHIEVE SPECIFIED COVERAGE RATES RECOMMENDED BY THE MANUFACTURER.

Any reproduction of these drawings is prohibited without written consent of Arch5 Design Studio. All dimensions and conditions on job site shall be verified prior to beginning of construction and shall immediately report any and all discrepancies to Designer.



2825 Dewey Road, Unit 207
San Diego, CA 92106
Phone: 619.546.9670

FALLBROOK
HEALTH & WELLNESS CENTER
1636 E. MISSION RD
FALLBROOK, CA 92028

REVISIONS

DATE	DESCRIPTION

Bid Issue Date: **TBD**

Date: **10/23/24**

Scale: **AS NOTED**

Project No.:

Sheet Title:

GENERAL NOTES

Sheet No.:

IDO.0

BID SET 10/23/24 - NOT FOR CONSTRUCTION

Any reproduction of these drawings is prohibited without written consent of Arch 5 Design Studio. All dimensions and conditions on job site shall be verified prior to beginning of construction and shall immediately report any and all discrepancies to Designer.

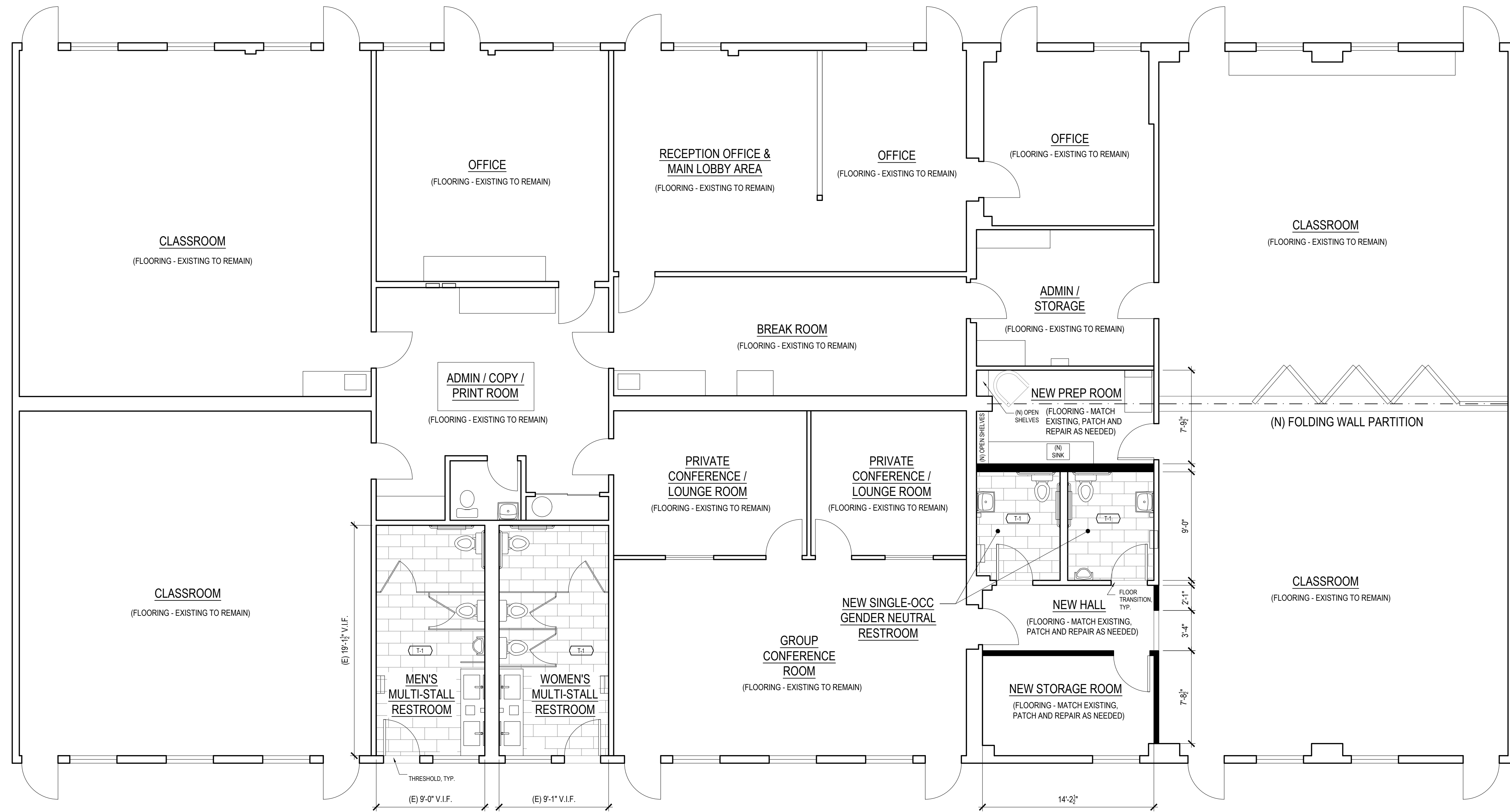

1 FINISH FLOOR PLAN
3/16" = 1'-0"

FINISH PLAN GENERAL NOTES

1. THE CONTRACTOR SHALL PROTECT EXISTING MATERIALS & FINISHES (SHOWN TO REMAIN) FROM DAMAGE DURING CONSTRUCTION. PROVIDE PROTECTION AS REQUIRED AND AS DIRECTED BY DESIGNER. THE CONTRACTOR IS RESPONSIBLE FOR THE REPAIR/REPLACEMENT OF MATERIALS, FINISHES AND ELEMENTS DAMAGED DURING CONSTRUCTION.
2. PROTECT EXISTING CONCRETE WALKWAYS DURING CONSTRUCTION. CLEAN AND REPAIR EXISTING CONCRETE WALKS AND STEPS, TYPICAL.
3. WALLS AND PARTITIONS WITHIN 2 FEET OF SERVICE SINKS, URINALS AND WATER CLOSETS SHALL HAVE A SMOOTH, HARD, NONABSORBENT SURFACE. TO A HEIGHT OF NOT LESS THAN 4 FEET ABOVE THE FLOOR, AND EXCEPT FOR STRUCTURAL ELEMENTS, THE MATERIALS USED IN SUCH WALLS SHALL BE OF A TYPE THAT IS NOT ADVERSELY AFFECTED BY MOISTURE. [CBC 1209.2.2]
4. REFER TO SHEET ID0.0 FOR FINISH GENERAL NOTES.
5. ALL FINISH SUBSTITUTIONS SHALL BE APPROVED BY THE ARCHITECT/DESIGN TEAM WITH FINISH SAMPLES FOR APPROVAL.
6. EXISTING SURFACES SHALL BE PATCHED AND REPAIRED AS REQUIRED PRIOR TO RECEIVING NEW FINISHES.
7. ALL SURFACES SHALL BE PRIMED PRIOR TO PAINTING.

NOTE:
GC TO VERIFY IN FIELD ALL EXISTING CONDITIONS PRIOR TO DEMOLITION, FABRICATION AND INSTALLATION.

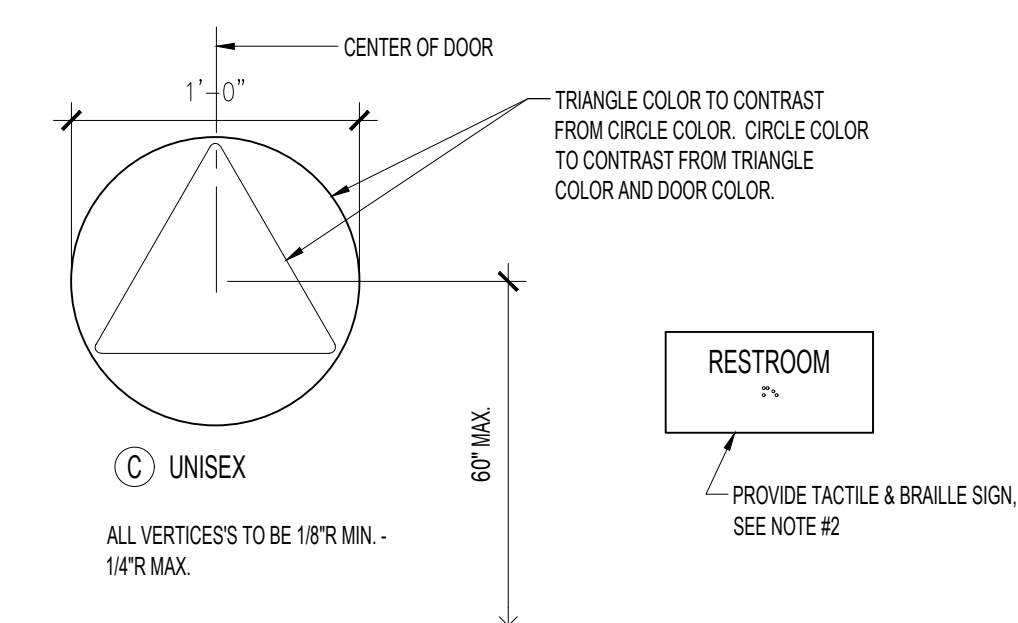

- NOTES:**
1. INTERNATIONAL SYMBOLS FOR UNISEX MINIMUM 1/4" THICKNESS CONTRASTING COLOR FROM DOOR.
 2. PROVIDE RAISED LETTERS AND BRAILLE SIGNAGE ON WALL ADJACENT TO DOOR 60" MAX. TO BASELINE OF HIGHEST RAISED TEXT 48" MIN. TO BASELINE OF BRAILLE AND SUCH THAT A PERSON MAY APPROACH WITHIN 3" WITHOUT ENCOUNTERING PROTRUDING OBJECTS OR DOOR SWING.
 3. BRAILLE: GRADE II, DOTS - 1/10" O.C. IN EACH CELL WITH 2/10" SPACE BETWEEN CELLS, RAISED 1/40".
 4. ALL SYMBOL EDGES TO BE EASED 1/16" R OR CHAMFERED 1/8".

2 RESTROOM UNISEX SIGNAGE
NTS

REF TAG	REF PATTERN	LOCATION	MATERIAL	SIZE	COLOR/STYLE	VENDOR/SUPPLIER	CONTACT	GROUT & GROUT SIZE	NOTES
T-1	INSTALL PATTERN	FLOOR TILE	MATTE PORCELAIN TILE	12" X 24"	BOND NIMBUS	TILEBAR	DANIELLE VOMBAUR (951) 642-3171	1/16" CUSTOM ROLLING FOG #544	
T-2	INSTALL PATTERN	WALL BASE	POLISHED PORCELAIN TILE	3" X 6"	PARK HILL LIGHT GRAY	TILEBAR	DANIELLE VOMBAUR (951) 642-3171	1/16" CUSTOM BRIGHT WHITE #381	
T-3	INSTALL PATTERN	WAINSCOTING	MATTE PORCELAIN TILE	12" X 24"	BOND INDIO BLUE	TILEBAR	DANIELLE VOMBAUR (951) 642-3171	1/16" CUSTOM DELOREAN GRAY #165	
CTP-1	INSTALL PATTERN	COUNTERTOP LAVATORIES	MATTE QUARTZ SLAB	132" X 65.5" 2CM THICKNESS	PORTRUSH MATTE	CAMBRIA	RENEE HAMPTON (714) 474-5699		
P-1	INSTALL PATTERN	ALL WALLS, U.O.N.	PAINT	N/A	SW 70296 AGREEABLE GRAY	SHERWIN-WILLIAMS	JOHN DUMENSIL (619) 665-9341		SEMI-GLOSS FOR RESTROOMS SATIN FOR ALL OTHER WALLS
SCH-1	INSTALL PATTERN	WALL BASE COVE	METAL COVE-SHAPED TILE EDGING TRIM	TBD BY TILE INSTALLER	DILEX-AHK BRUSHED STAINLESS STEEL	SCHLUTER	KRYSTA WIEGERS (212) 246-4169 EXT. 528		
SCH-2	INSTALL PATTERN	WAINSCOTING TRANSITION	METAL FINISHING AND EDGE PROTECTION PROFILE	TBD BY TILE INSTALLER	QUADEC BRUSHED STAINLESS STEEL	SCHLUTER	KRYSTA WIEGERS (212) 246-4169 EXT. 528		

RESTROOM ACCESSORIES LEGEND			
KEY	MODEL NUMBER	DESCRIPTION	
A	B-3944	BOBRICK	RECESSED CONVERTIBLE PAPER TOWEL DISPENSER AND WASTE RECEPTACLE
B	B-3949	BOBRICK	SURFACE-MOUNTED CONVERTIBLE PAPER TOWEL DISPENSER AND WASTE RECEPTACLE
C	B-2012	BOBRICK	AUTOMATIC WALL-MOUNTED SOAP DISPENSER
D	B-167	BOBRICK	18"X44" GLASS MIRROR WITH STAINLESS STEEL ANGLE FRAME
E	B-167	BOBRICK	24"X48" GLASS MIRROR WITH STAINLESS STEEL ANGLE FRAME
F	B-30919	BOBRICK	SURFACE-MOUNTED TOILET SEAT-COVER DISPENSER, WASTE DISPOSAL, AND TOILET TISSUE DISPENSER
G	B-30929	BOBRICK	SURFACE-MOUNTED TOILET SEAT-COVER DISPENSER, WASTE DISPOSAL, AND TOILET TISSUE DISPENSER
H	B-76717	BOBRICK	SURFACE-MOUNTED ROBE HOOK
J	B-5806 X 36 B-5806 X 42	BOBRICK	STAINLESS STEEL GRAB BARS WITH SNAP FLANGE
K	S-25747	ULINE	GENDER NEUTRAL SIGNAGE, SEE DETAIL AAS.2
L	ONE PART PARTITIONS		POWDER COATED STEEL RESTROOM PARTITIONS

PLUMBING FIXTURE LEGEND			
KEY	FIXTURE	MODEL NUMBER	DESCRIPTION
1	FLOOR MOUNTED WATER CLOSET	2857.128 5905.100	AMERICAN STANDARD MADERA FLOWISE 16-1/2" HEIGHT 1.28 GPF FLUSHMETER TOILET SYSTEM ELONGATED EXTRA HEAVY DUTY BOWL OPEN FRONT SEAT LESS COVER
2	WALL MOUNTED URINAL	6063.013.002	AMERICAN STANDARD WASHBROOK FLOWISE UNIVERSAL URINAL WITH EVERCLEAN
3	WALL MOUNTED LAVATORY	23105500002	DIURAVIT D-CODE 21-5/8" SPECIALTY CERAMIC WALL MOUNTED BATHROOM SINK WITH OVERFLOW AND ONE FAUCET HOLE
4	UNDERMOUNTED LAVATORY	K-2215	KOHLER LADENA 23-1/4" UNDERMOUNT BATHROOM SINK WITH OVERFLOW
5	DECK MOUNTED LAVATORY FAUCET	7758205.002	AMERICAN STANDARD NEXTGEN SELECTRONIC 0.5 GPM SINGLE HOLE BATHROOM FAUCET WITH TEMPERATURE MIXING LEVER

- RESTROOM GENERAL NOTES**
1. FLOOR AND WALL FINISH IN TOILET ROOMS SHALL BE SURFACED WITH A SMOOTH HARD NON-ABSORBENT MATERIAL EXTENDING A MINIMUM OF 4" UP THE WALL [CBC SEC. 1210.2]
 2. WALLS WITHIN 2' OF FRONT OF URINALS AND WATER CLOSETS WILL BE SMOOTH AND OF A HARD NON-ABSORBENT SURFACE TO A HEIGHT OF 4'. [CBC SEC. 1210.2]
 3. HAND OPERATED FLUSH CONTROL SHALL BE MOUNTED AT A MAXIMUM HEIGHT OF 44 INCHES ABOVE FINISH FLOOR. [CBC SEC. 11B-605.4]
 4. FAUCET CONTROLS SHALL BE OPERABLE WITH ONE HAND AND SHALL NOT REQUIRE TIGHT GRASPING, PINCHING, OR TWISTING OF THE WRIST. [CBC SEC. 11B-606.2]
 5. WATER SUPPLY AND DRAIN PIPES UNDER LAVATORIES AND SINKS SHALL BE INSULATED. THERE SHALL BE NO SHARP OR ABRASIVE SURFACES UNDER LAVATORIES OR SINKS. [CBC SEC. 11B-606.5]



2825 Dewey Road, Unit 207
San Diego, CA 92106
Phone: 619.546.9670

FALLBROOK
HEALTH & WELLNESS CENTER
1636 E. MISSION RD
FALLBROOK, CA 92028

REVISIONS	
DATE	DESCRIPTION

Bid Issue Date: TBD
Date: 10/23/24
Scale: AS NOTED
Project No.:
Sheet Title:

FINISH PLAN & SCHEDULES
Sheet No.:
ID1.0

BID SET 10/23/24 - NOT FOR CONSTRUCTION

